

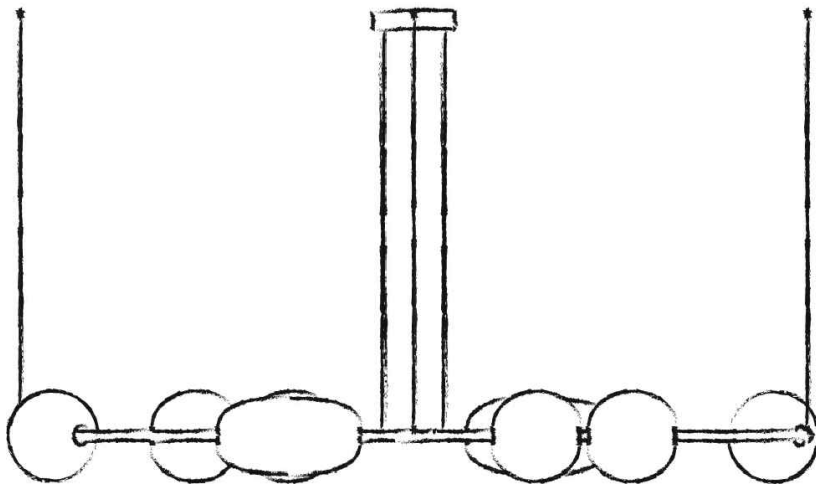

MADE IN ITALY



SOSPENSIONE ORIZZONTALE - SATELLITE -  
HORIZONTAL HANGING LAMP

# SATELLITE Studio Pepe

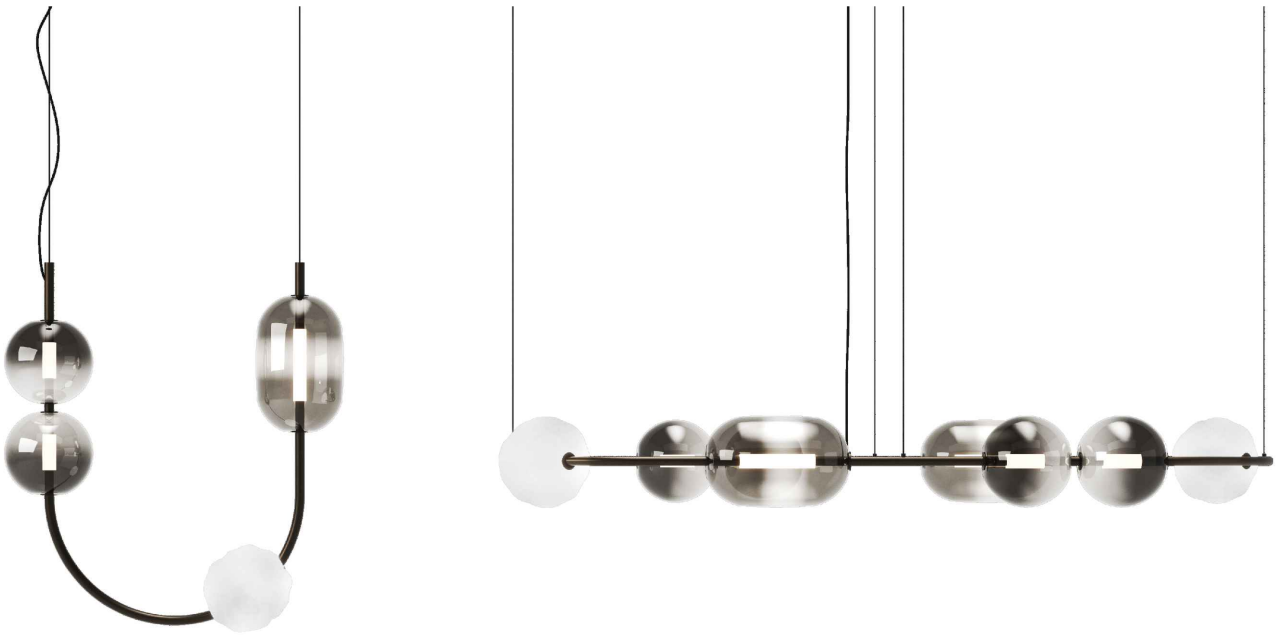

Orizzontale / *Horizontal* 216x94 h 24  
Lampada sospensione  
*Hanging Lamp*

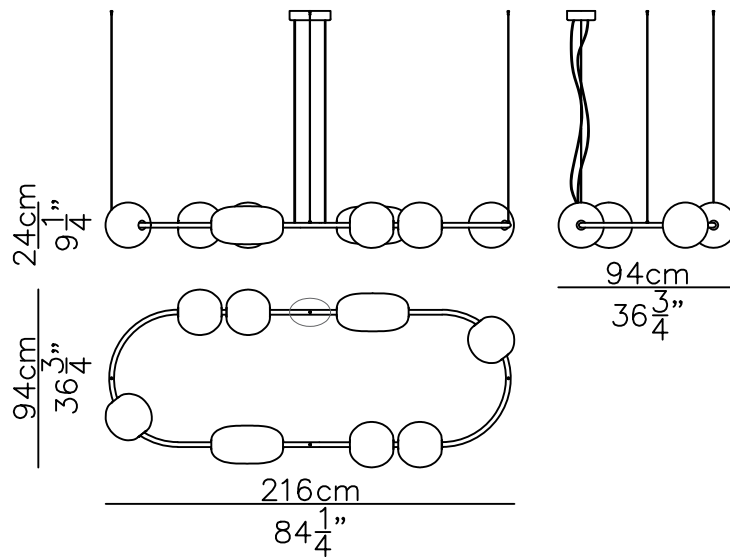

# SATELLITE Studio Pepe

## LAMPADA ORIZZONTALE / HORIZONTAL LAMP

SORGENTE LUMINOSA LIGHT SOURCE	POTENZA POWER	FLUSSO LUMINOSO LUMEN FLUX	ALIMENTAZIONE SUPPLY	TEMPERATURA COLOUR TEMPERATURE	INDICE RESA CROMATICA COLOUR RENDERING INDEX
LED STRIP	24	9400	110÷240 V	3000 °K	>90



Tutti i prodotti sono conformi alle norme EN 60598-1 e alle parti seconde applicabili nonché alle norme EMC applicabili.

All the products are in compliance to EN 60598-1 and part two applicable standards and to EMC applicable standards.

# IP20

Protetto dalla penetrazione di corpi solidi di dimensioni maggiori a 12 mm  
- Non protetto

Protected against penetration of solid bodies measuring more than 12 mm  
- Not protected

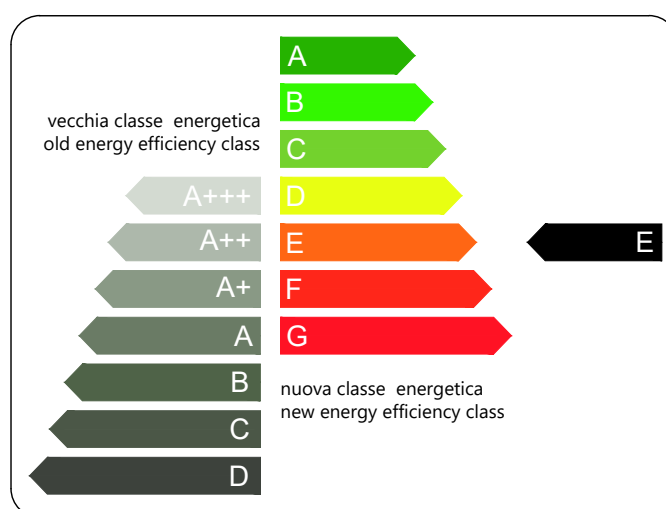

# COMPONENTI / COMPONENTS

n° 04 - Corpo lampada / *Lamp*

n° 06 - Paralume forma sferica / *Spherical lampshade*

n° 02 - Paralume forma ovale / *Oval lampshade*

n° 16 - Ghiera metallica + ferma ghiera / *Metal locking ring*

n° 32 - Copri ghiera magnetici / *Magnetic ring cover*

n° 08 - Tasselli + viti da muro / *Fasteners + wall screws*

n° 32 - Viti svasate M3x4mm / *Flat head screw M3x4mm*



Ingombro piastra e interasse fori. ( *Figura 1 - Fase 1* )  
*Bracket's size and holes's centre distance. ( Picture 1 - Step 1 )*



## Figura 2 - Picture 2

### Fase 2 - Step 2

Vista assonometrica / Isometric view

Estrarre dalla scatola la lampada che sarà divisa in quattro strutture e due tubi di giunzione. Rimuovere i cavi di sospensione  
*Take the lamp out of the box. It is supplied in four structures and two junction tubes. Remove suspension cable.*

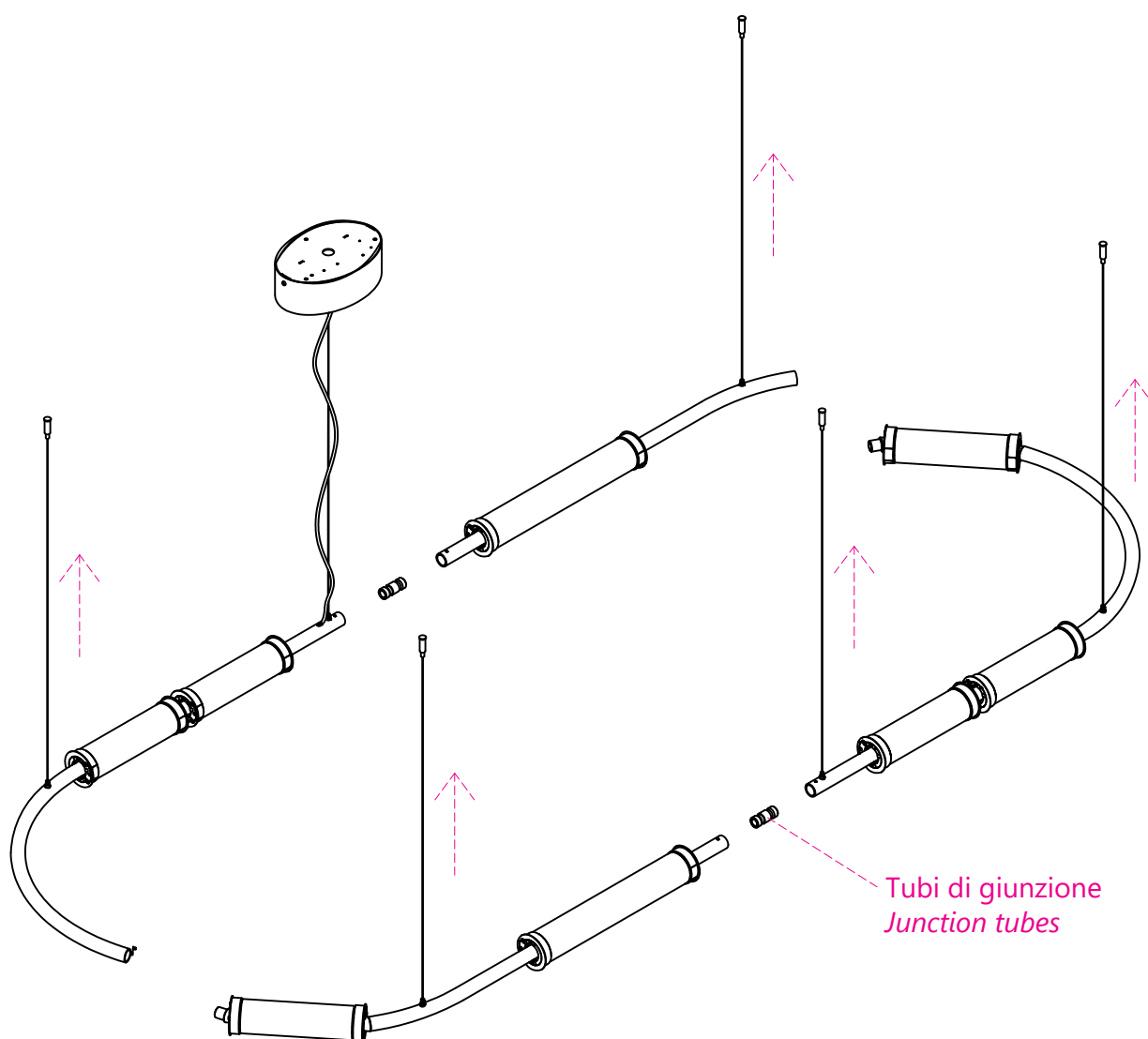

## Figura 3 - Picture 3

### Fase 3 - Step 3

Vista frontale / Front view

Rimuovere cavi in acciaio, svitare rosone e scollegare cavi elettrici  
*Remove the suspension cables, remove the canopy and disconnect electrical cables.*

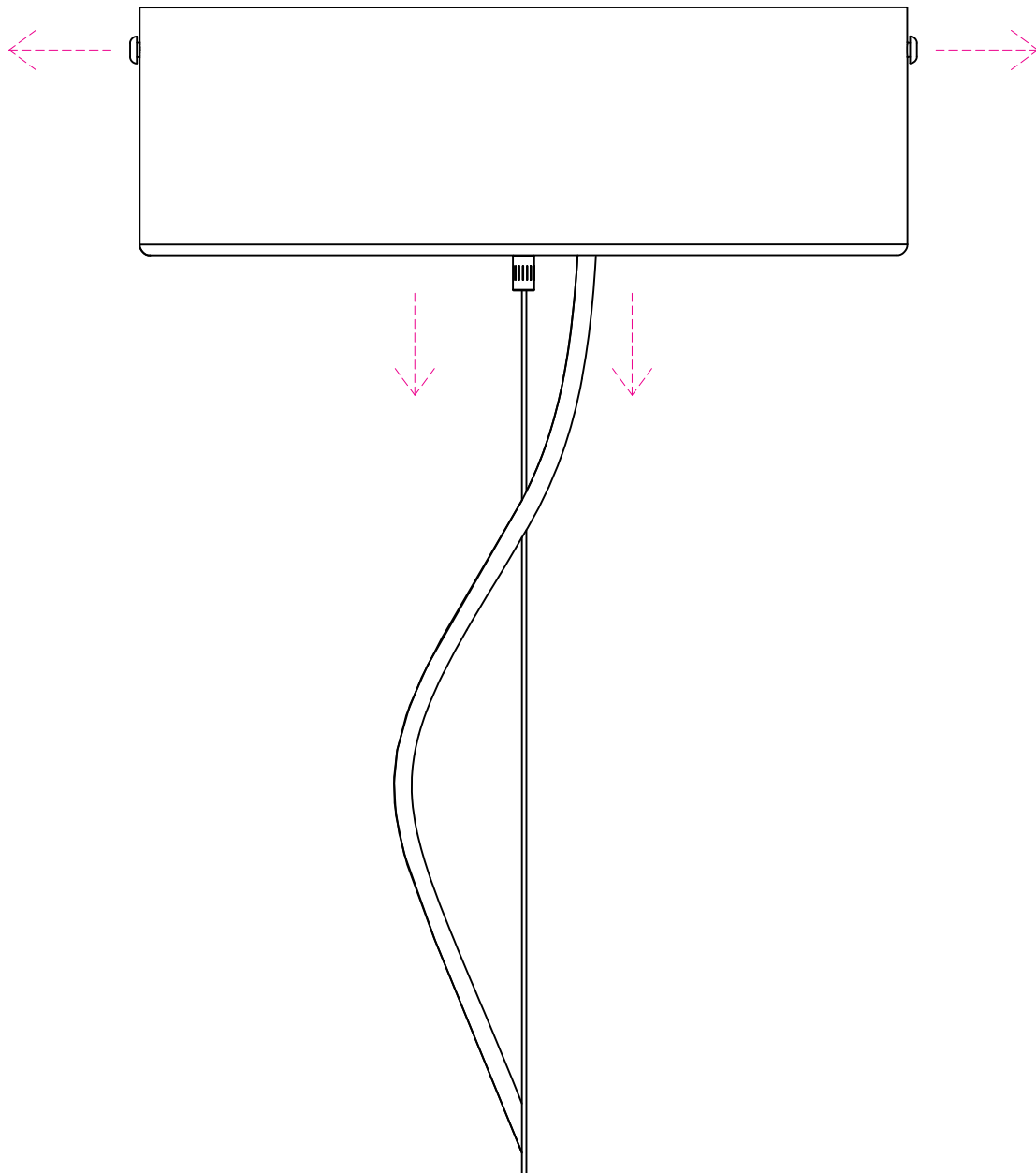

## Figura 4 - Picture 4

### Fase 4 - Step 4

Vista assonometrica / Isometric view

Segnare la posizione ed effettuare i fori per fissare la piastra a soffitto.  
Mark the position and drill the holes to fix the metal bracket on ceiling.

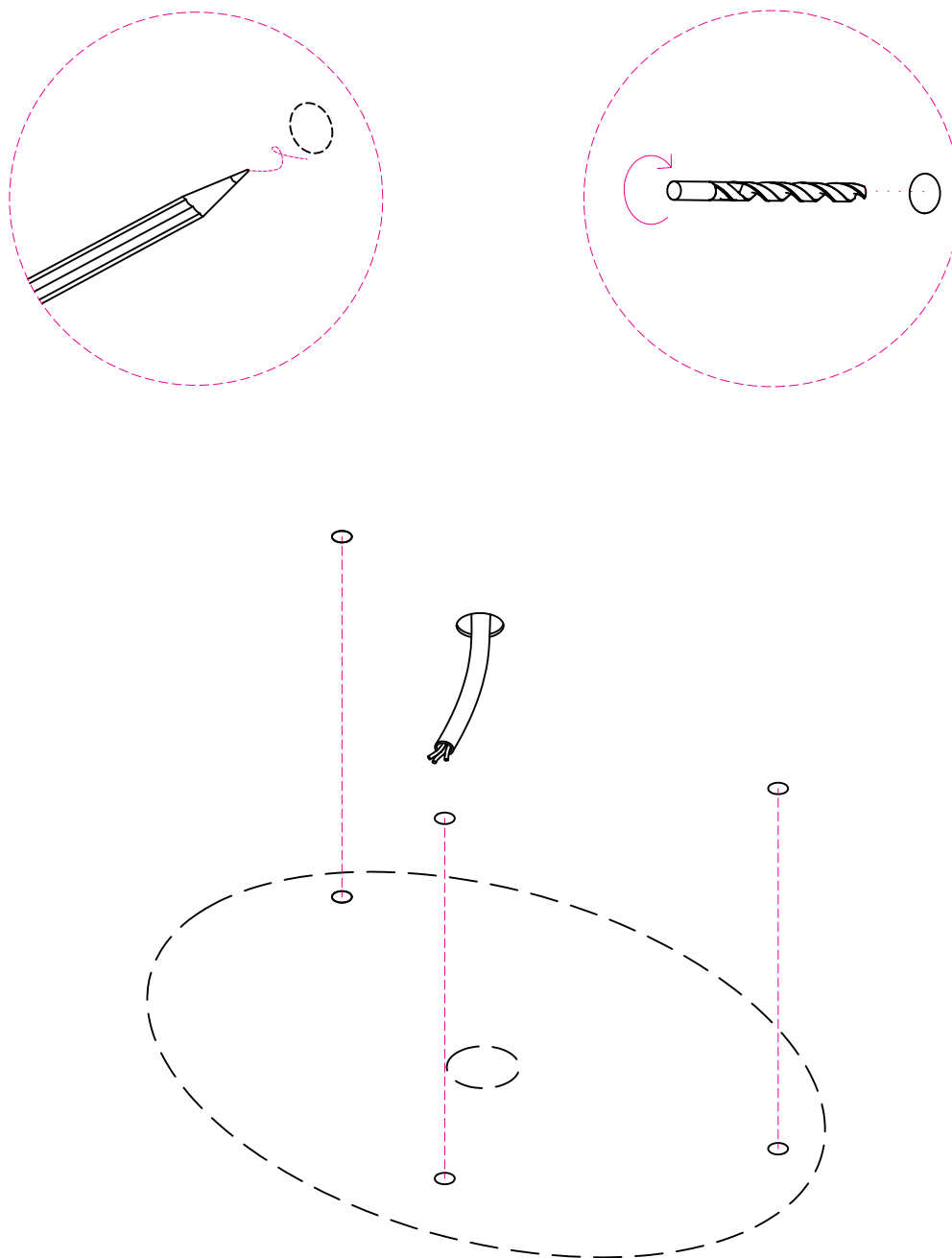

## Figura 5 - Picture 5

### Fase 5 - Step 5

Vista assonometrica / Isometric view

Inserire i tasselli nei fori, far passare i cavi attraverso la staffa e avvitare a soffitto.

*Insert the anchors in the holes, thread the cables through the bracket and screwd it on ceiling.*

**Staffa**  
**Bracket**

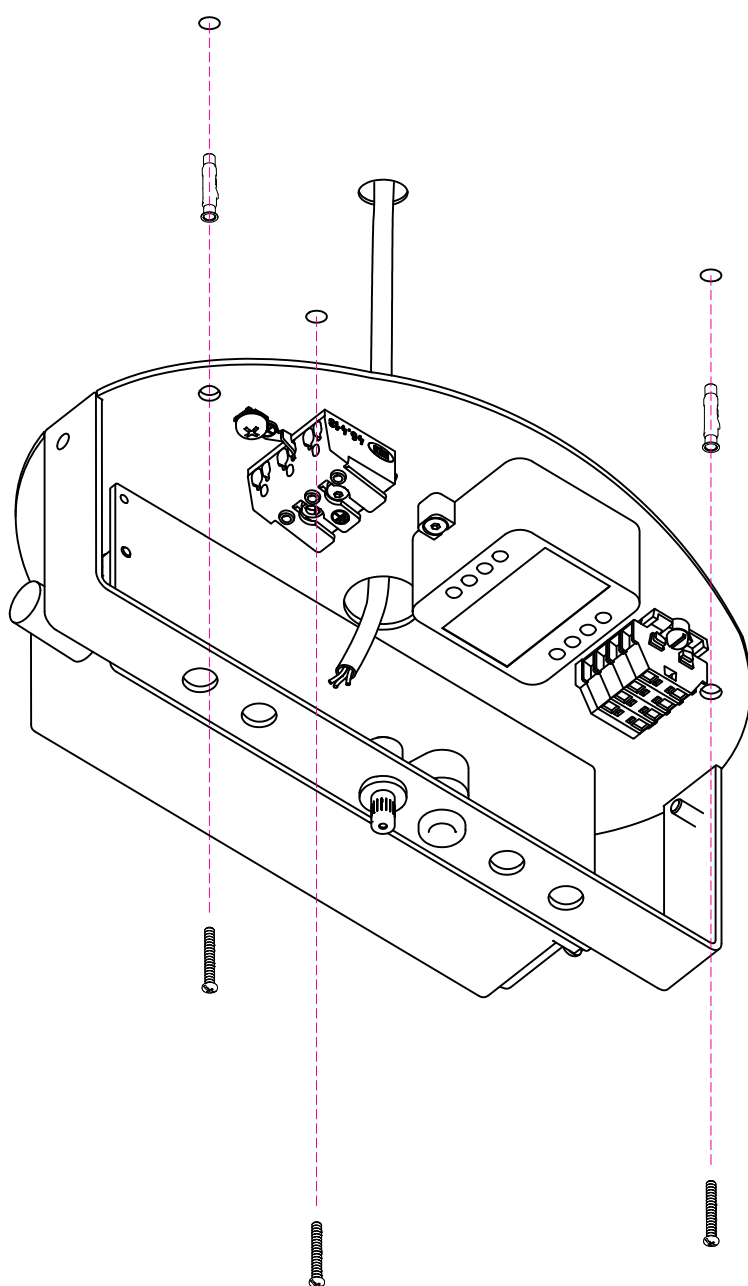

**Pendini**  
**Suspension cable**

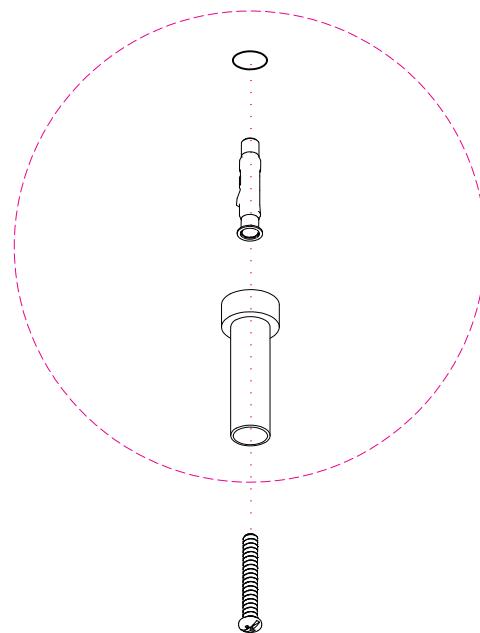

## Figura 6 - Picture 6

### Fase 6 - Step 6

Vista frontale / Front view

Montare le ghiera metalliche nelle posizioni indicate.  
Eseguire il passaggio per entrambe le strutture.  
*Install the metal locking rings in the indicated positions.  
Repeat the step for both structures*

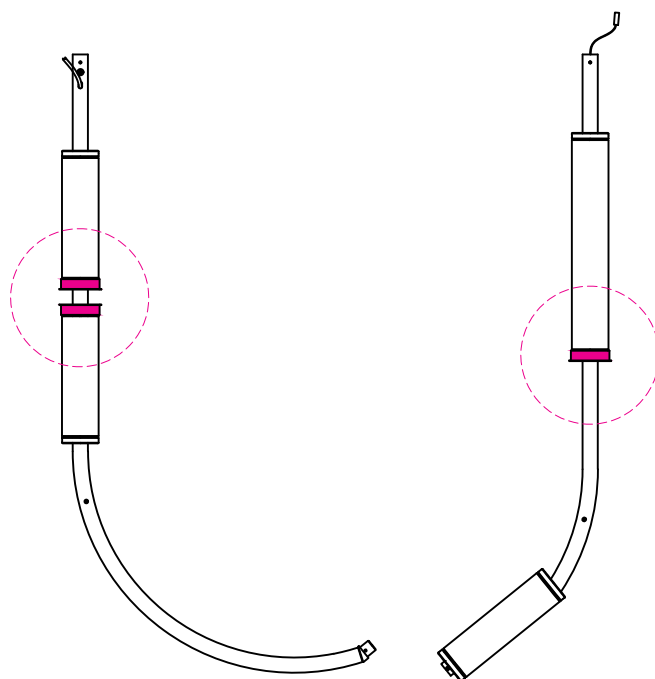

Vista assometrica / Isometric view

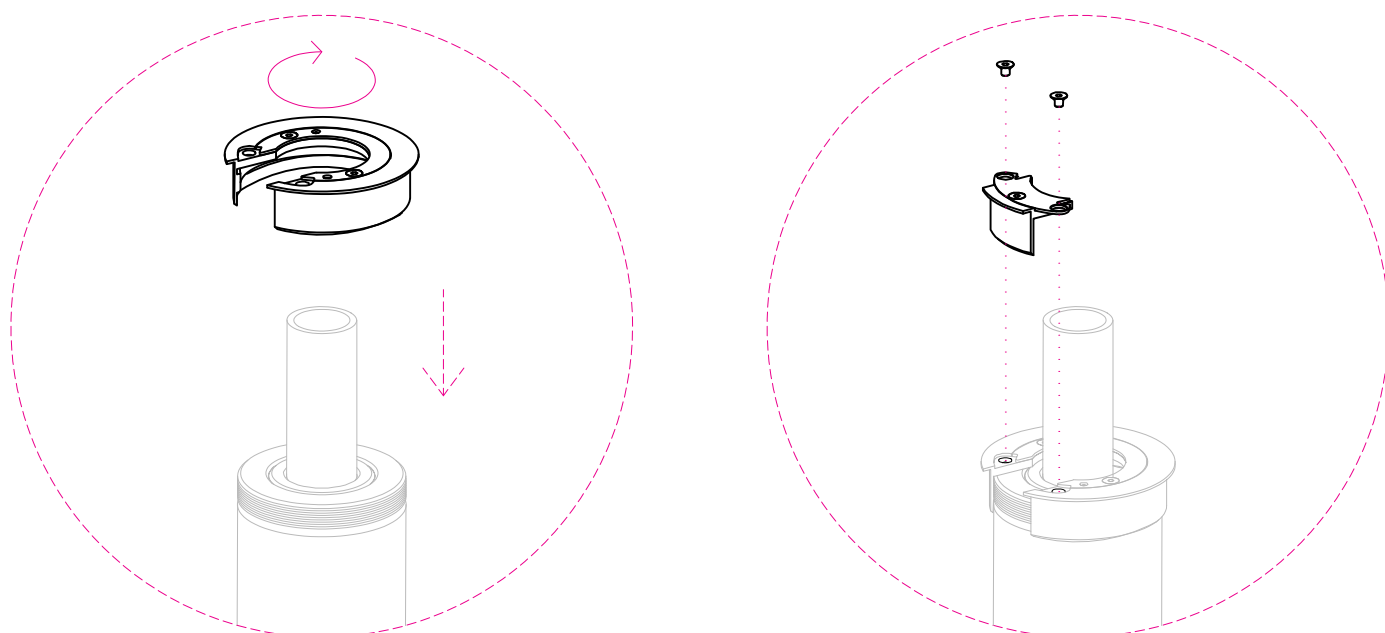

## Figura 7 - Picture 7

### Fase 7 - Step 7

Vista frontale / Front view

Inserire il primo paralume e fissarlo avvitando la ghiera metallica.  
*Insert the first lampshade and secure it by screwing on the metal locking ring.*

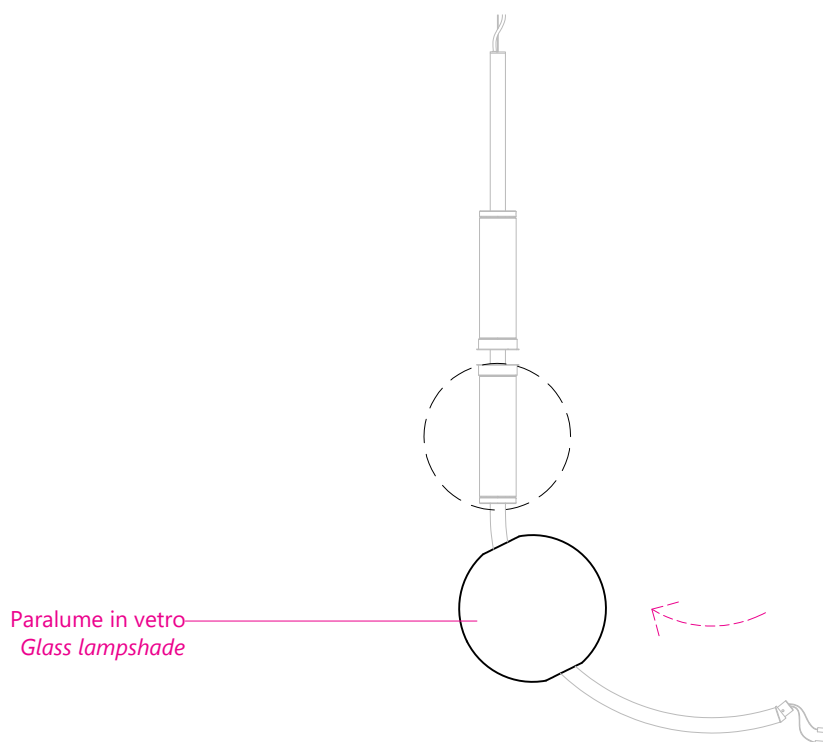

Vista assometrica / Isometric view

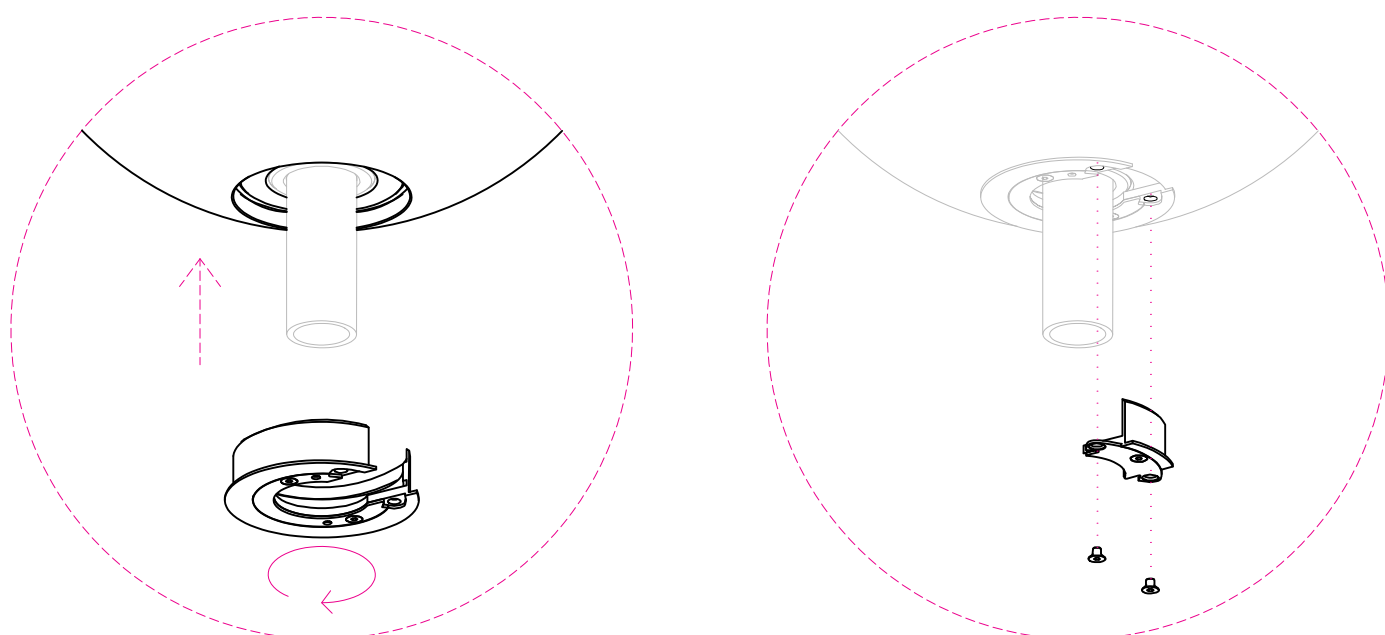

## Figura 8 - Picture 8

### Fase 8 - Step 8

Vista frontale / Front view

Inserire il secondo paralume nella seconda struttura, oltre la sua posizione ultima. Effettuare il collegamento elettrico tra le due strutture.

*Slide the second shade onto the second structure, pushing it beyond its final position. Establish the electrical connection between the two frames.*

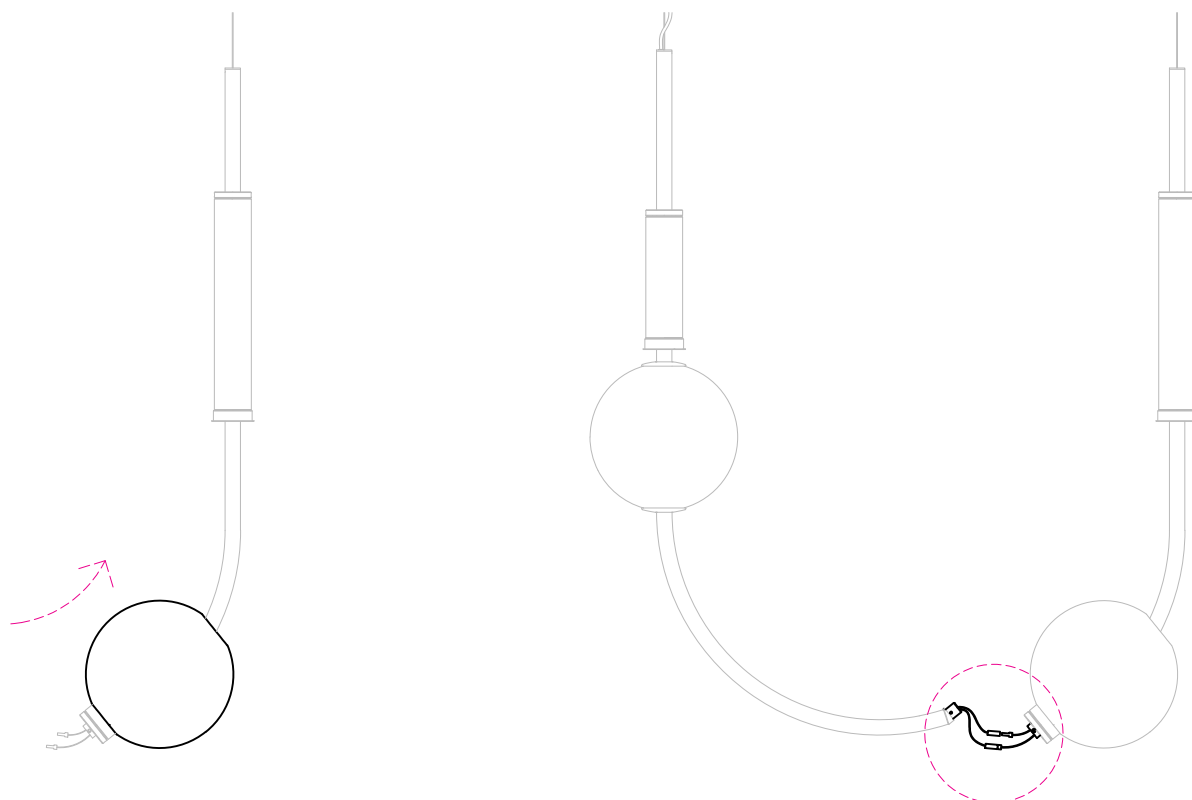

Vista assometrica / Isometric view

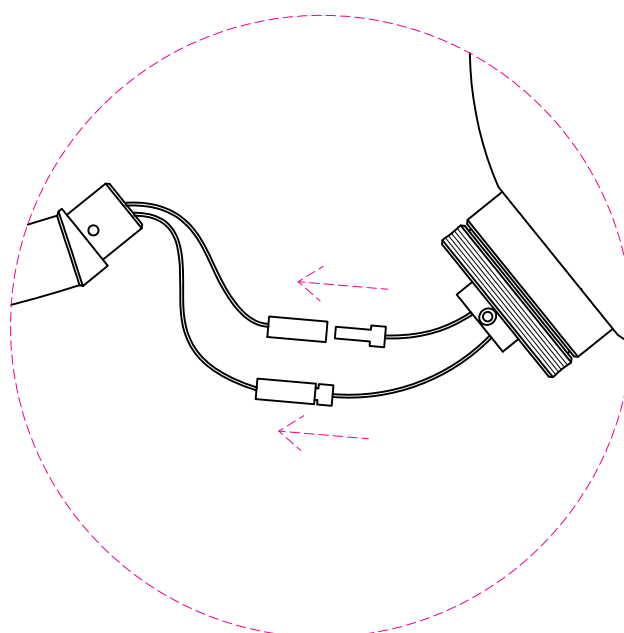

## Figura 9 - Picture 9

### Fase 9 - Step 9

Vista frontale / *Front view*

Collegare le due strutture inserendo i tubi uno dentro l'altro.  
*Connect the two frames by sliding the tubes into each other.*

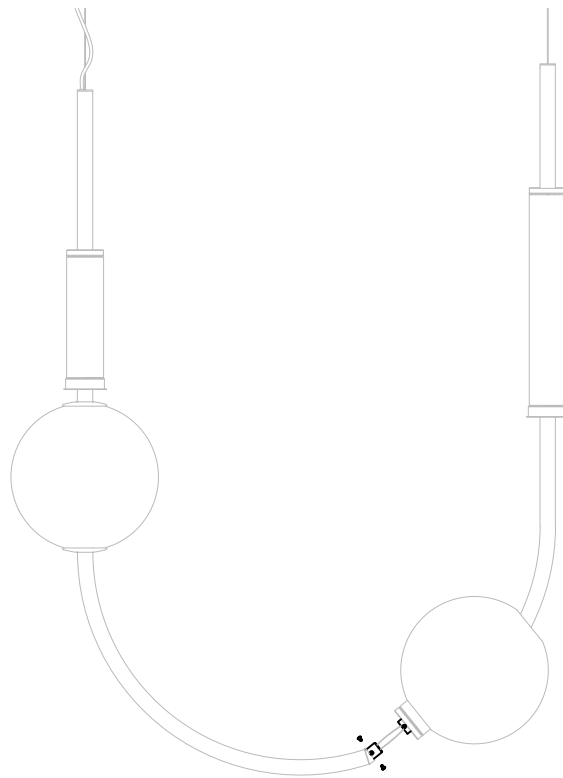

Vista assonometrica / *Isometric view*

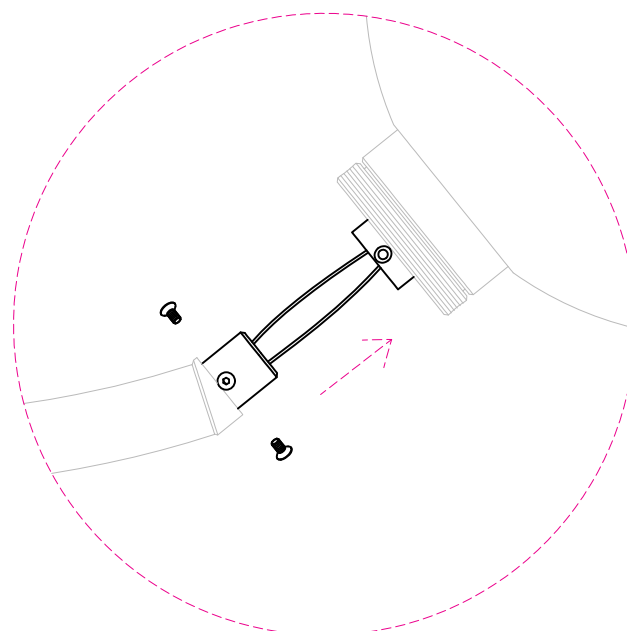

## Figura 10 - Picture 10

### Fase 10 - Step 10

Vista frontale / Front view

Far scorrere il paralume in posizione e fissarlo avvitando la ghiera metallica.  
Slide the lampshade into position and secure it by screwing on the metal locking ring.

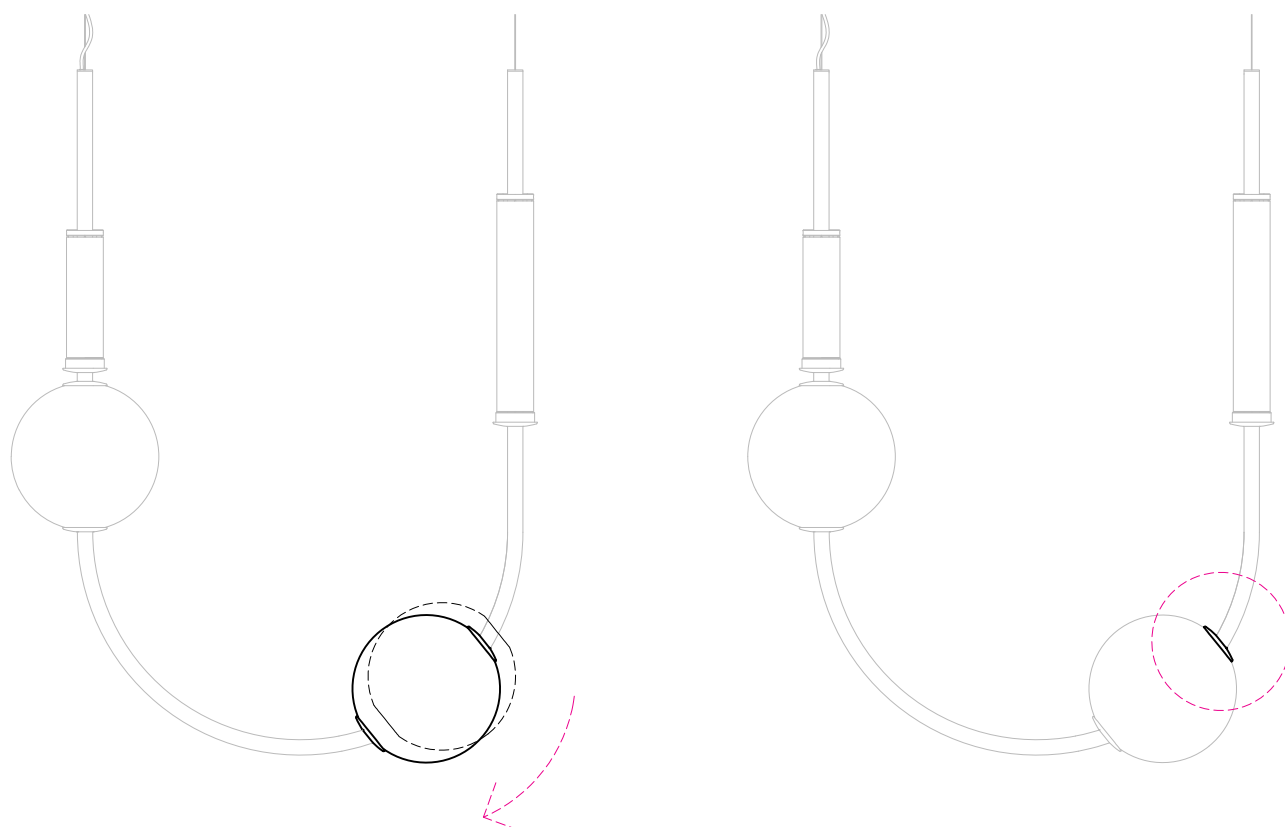

Vista assometrica / Isometric view

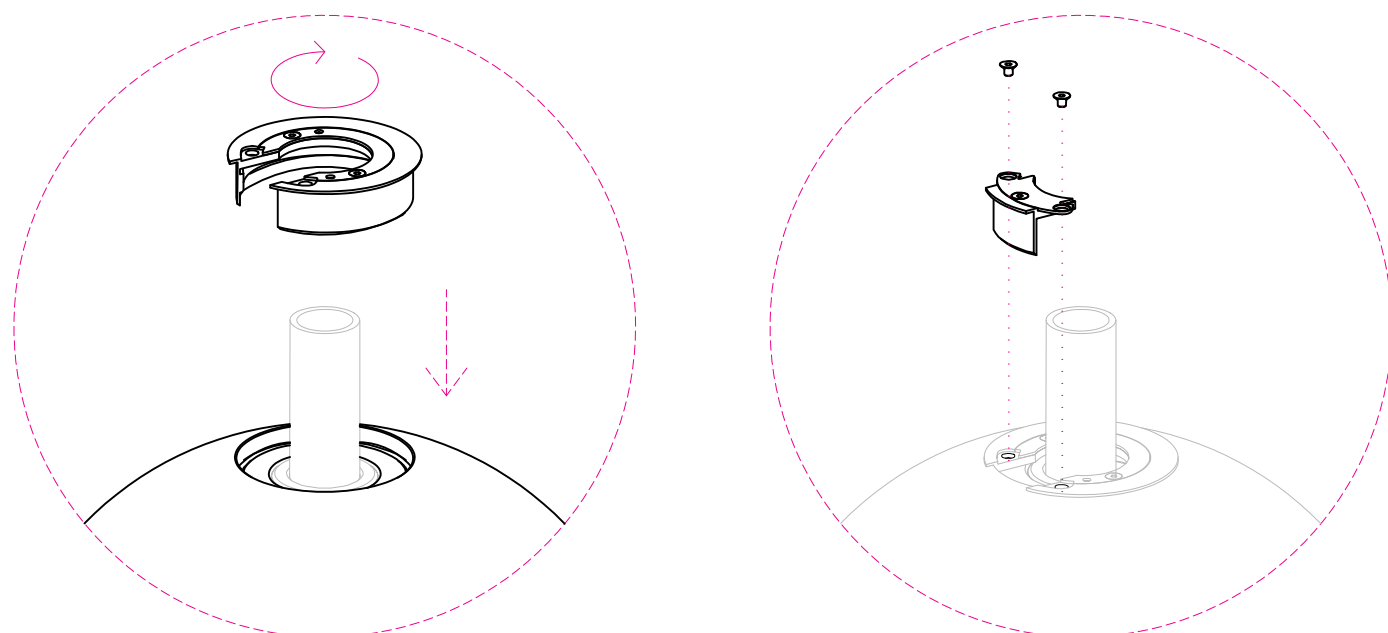

## Figura 11 - Picture 11

### Fase 11 - Step 11

Vista frontale / Front view

Inserire il terzo paralume e fissarlo avvitando la ghiera metallica.  
*Insert the third lampshade and secure it by screwing on the metal locking ring.*

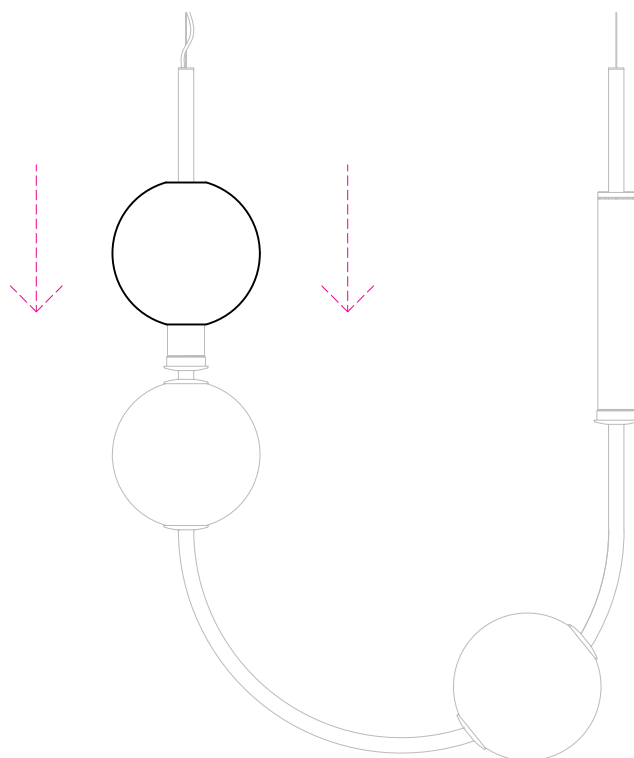

Vista assometrica / Isometric view

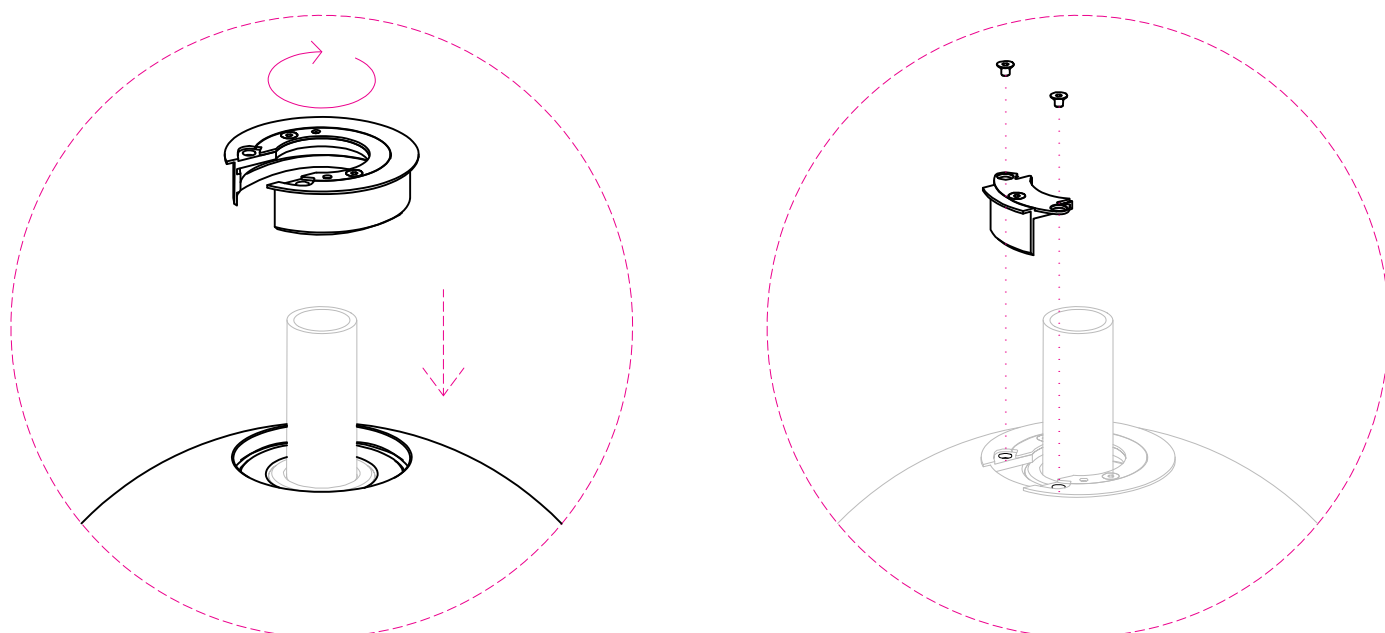

## Figura 12 - Picture 12

### Fase 12 - Step 12

Vista frontale / Front view

Inserire il quarto paralume e fissarlo avvitando la ghiera metallica.  
*Insert the fourth lampshade and secure it by screwing on the metal locking ring.*

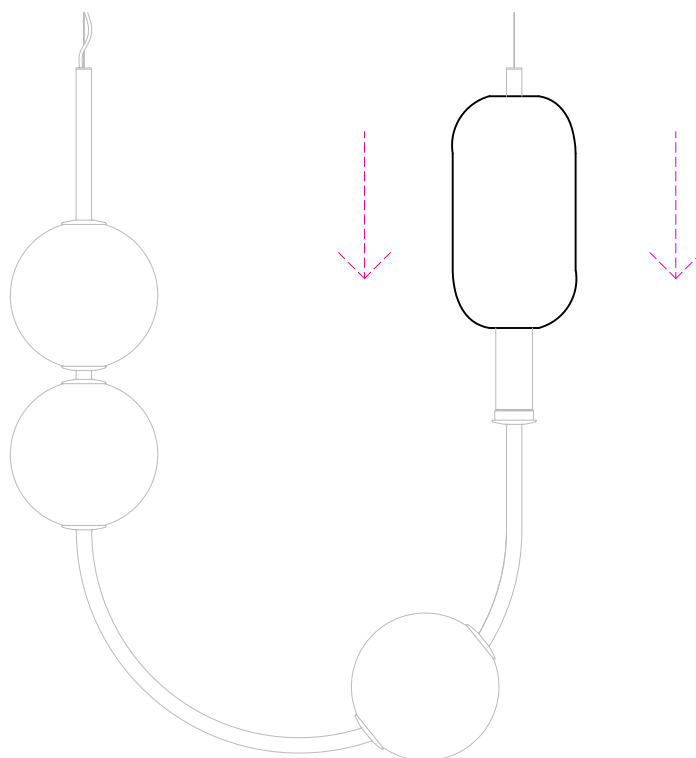

Vista assometrica / Isometric view

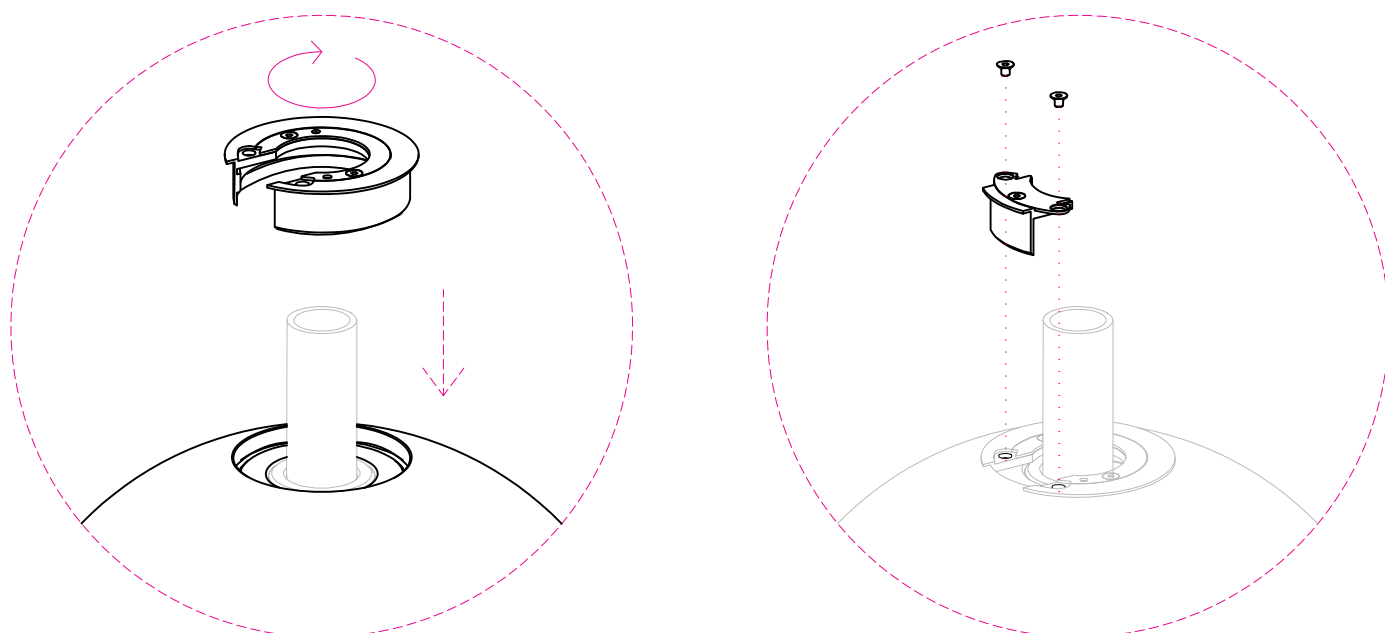

## Figura 13 - Picture 13

### Fase 13 - Step 13

Vista assonometrica / Isometric view

Dopo aver fissato tutti i paralumi, posizionare i copri ghiera magnetici.  
*After securing all the lampshades, place the magnetic ring covers.*

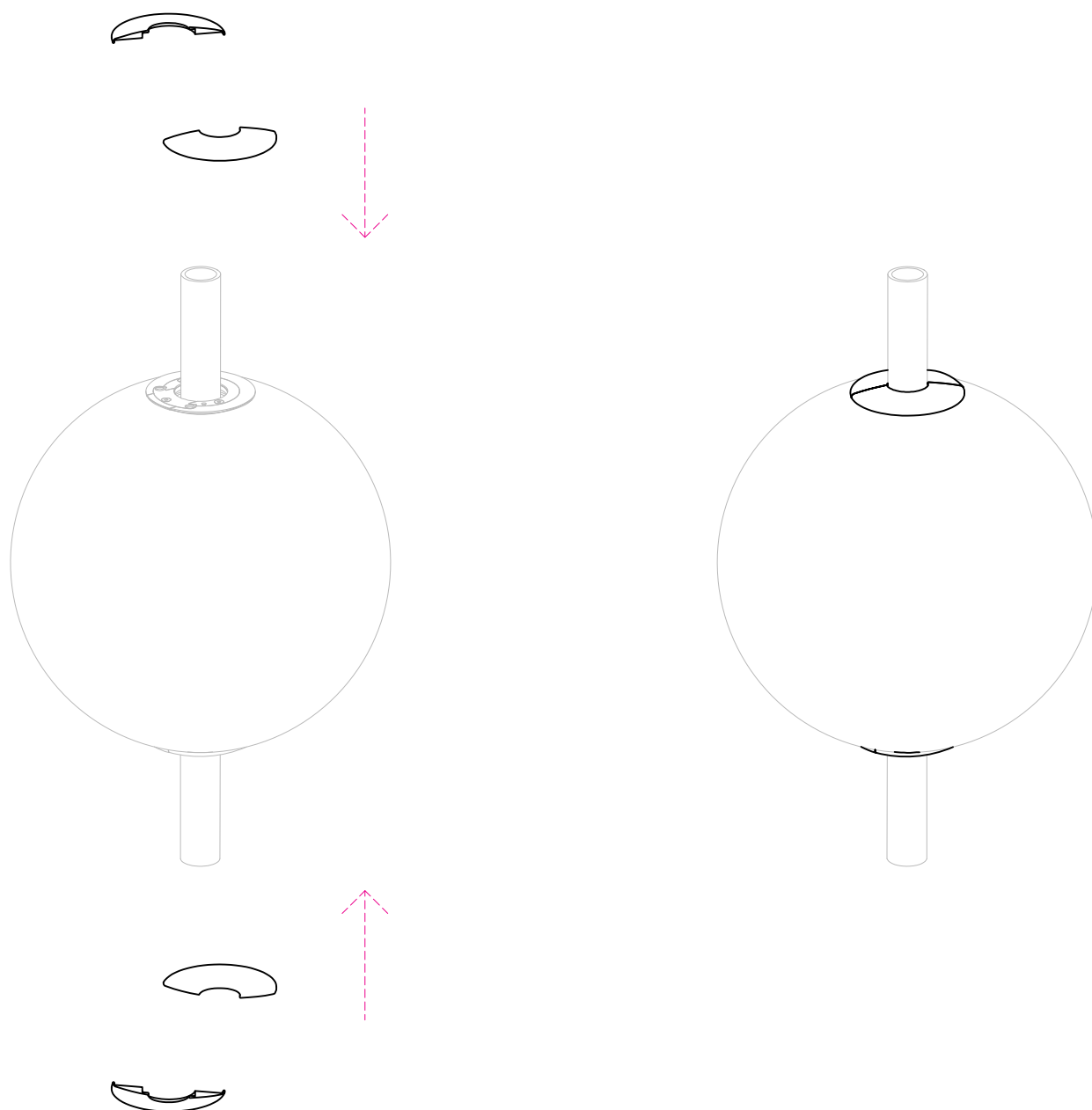

## Figura 14 - Picture 14

### Fase 14 - Step 14

Vista assonometrica / Isometric view

Collegare tra di loro le due strutture:

1. collegare cavi elettrici.
2. inserire le due strutture nel tubo e fissarle avvitando i grani

*Connect the two structures to each other:*

1. connect the electrical cables.
2. insert the two structures into the tube and fix them together.

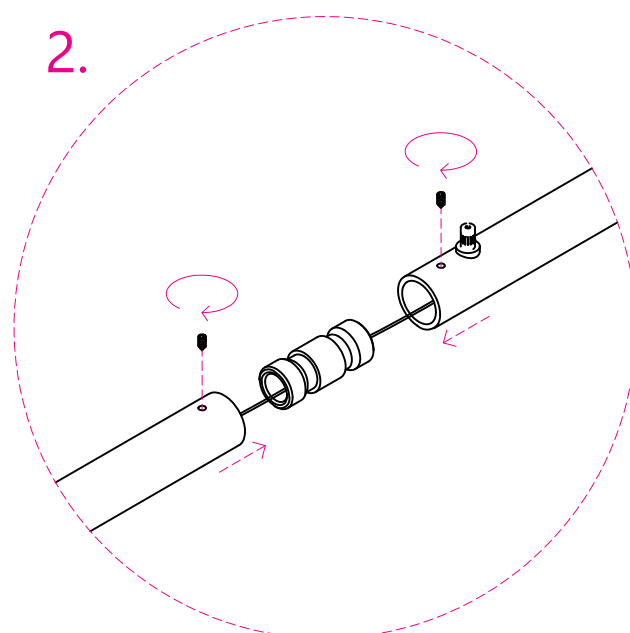
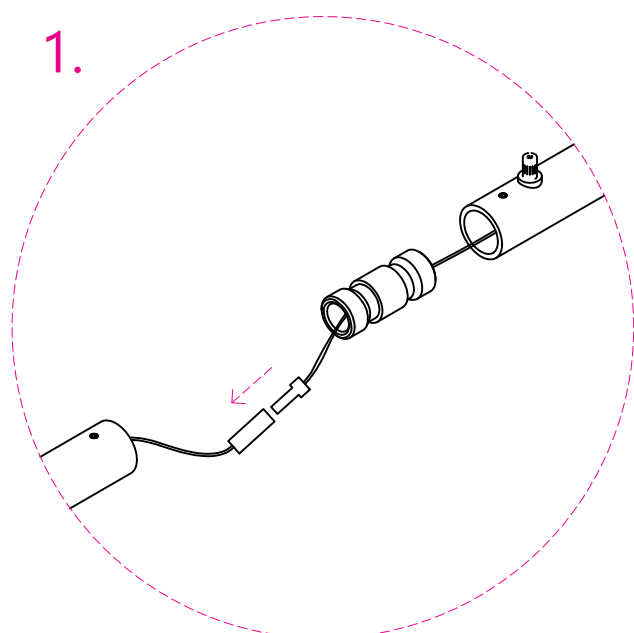
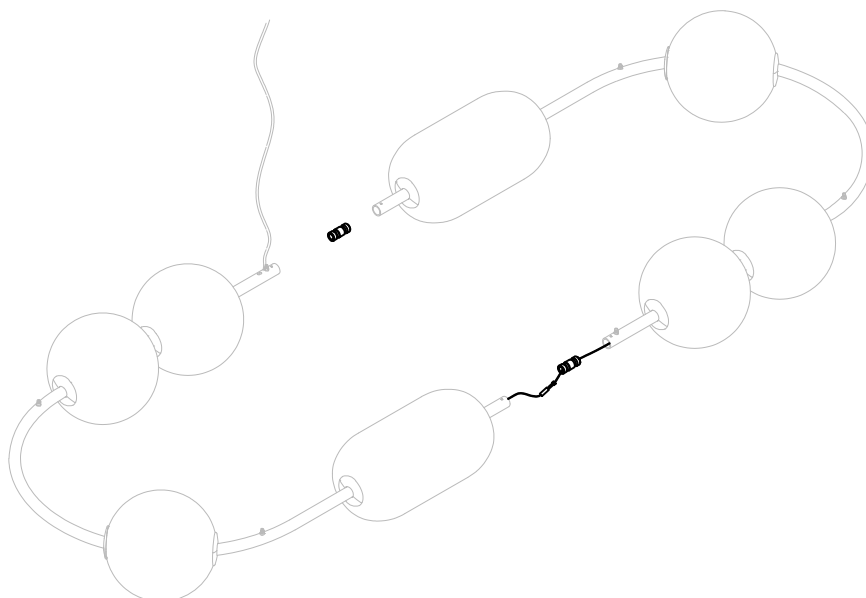

## Figura 15 - Picture 15

### Fase 15 - Step 15

Vista assonometrica / Isometric view

inserire cavi di sospensione  
*insert suspension cables.*

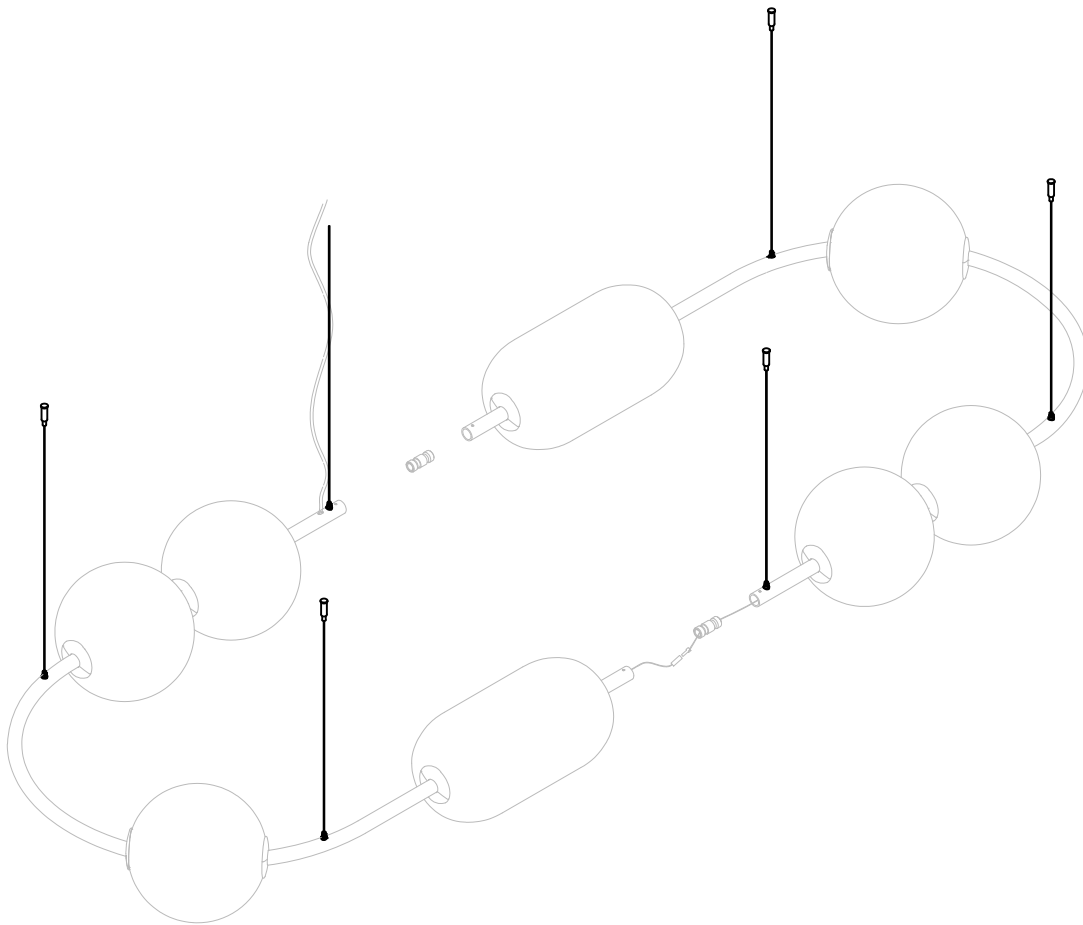

## Figura 16 - Picture 16

### Fase 16 - Step 16

Vista assonometrica / Isometric view

Inserire i cavi in acciaio all'interno del ferma cavo.

Regolare la lunghezza della lampada premendo delicatamente il ferma cavo.

Durante la regolazione premere con la punta del dito senza piegare il cavo metallico.

*Insert the steel cables into the cable blocker.*

*Adjust the lamp's length by gently pressing the cable blocker. While adjusting, press with your fingertip without bending the metal cable.*

#### Rosone Canopy

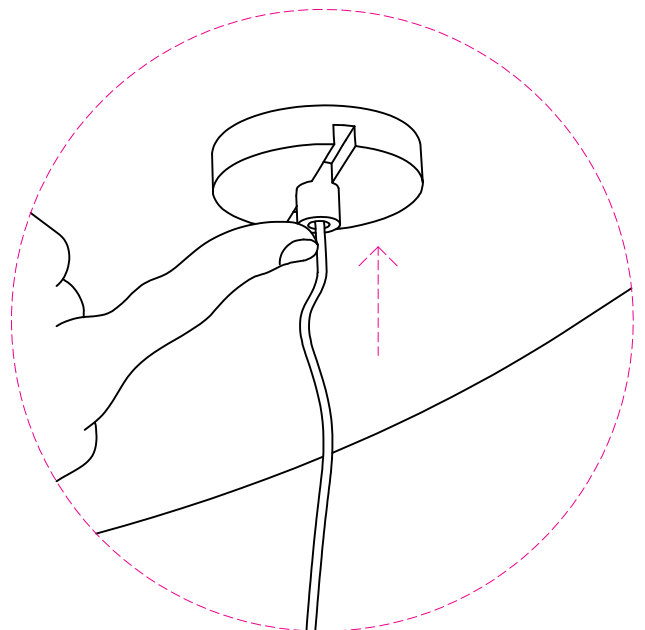
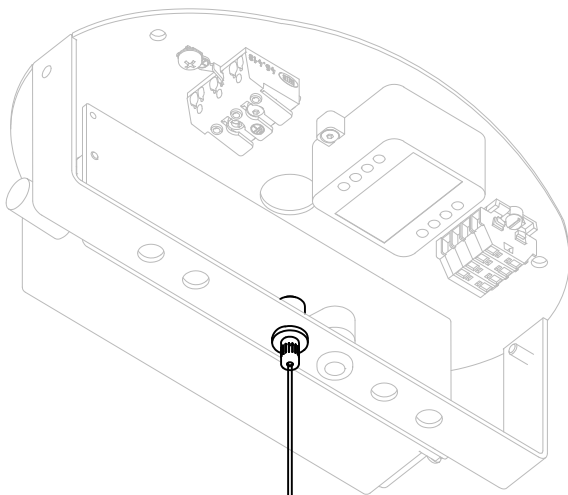

#### Pendini Suspension cable

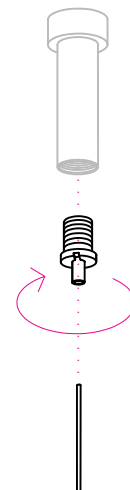
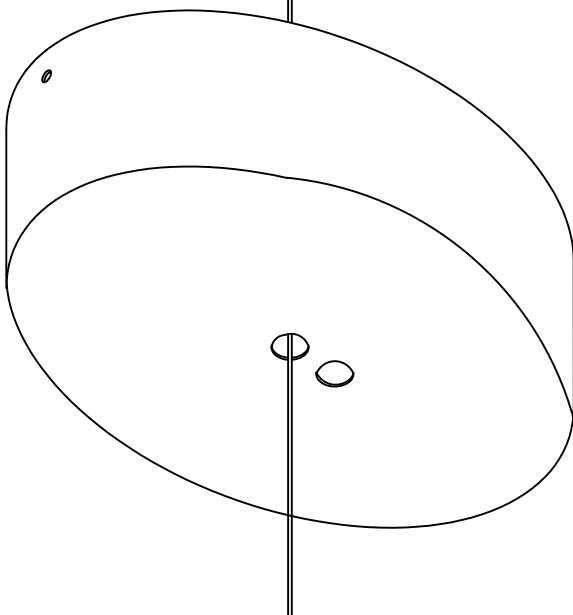

## Figura 17 - Picture 17

### Fase 17 - Step 17

Vista assonometrica / Isometric view

Infilare i cavi di alimentazione nel fermacavo della staffa.  
*Insert the power cable into the bracket clamp.*

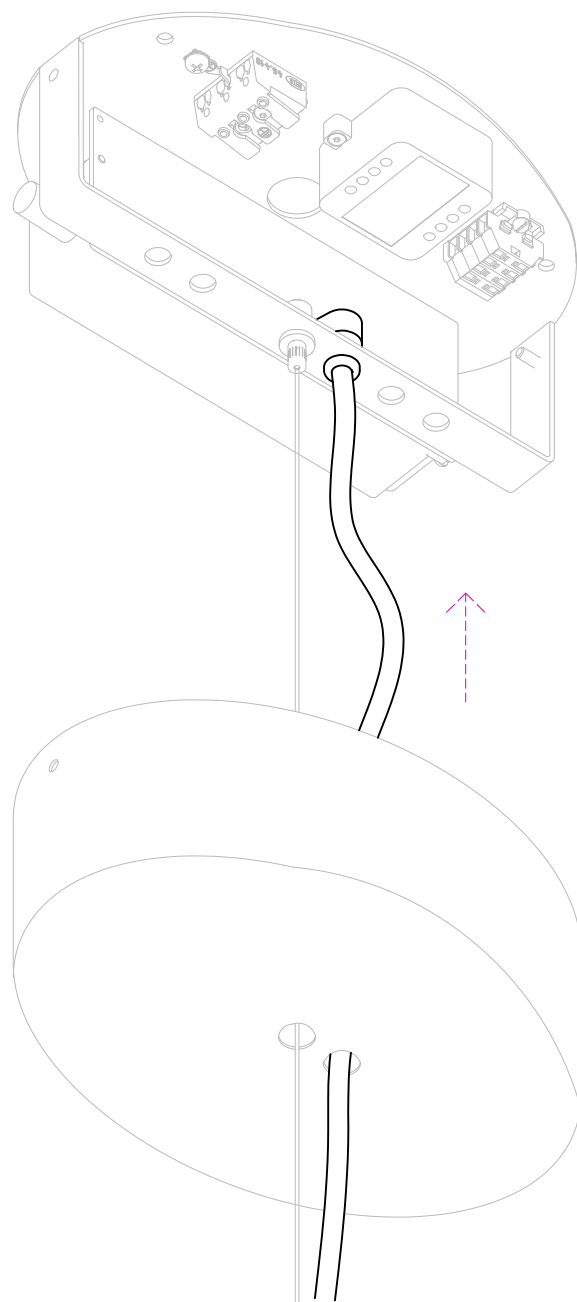

## Figura 18 - Picture 18

Fase 18 - Step 18

Effettuare il collegamento elettrico.  
Connect the power cables to the transformer.

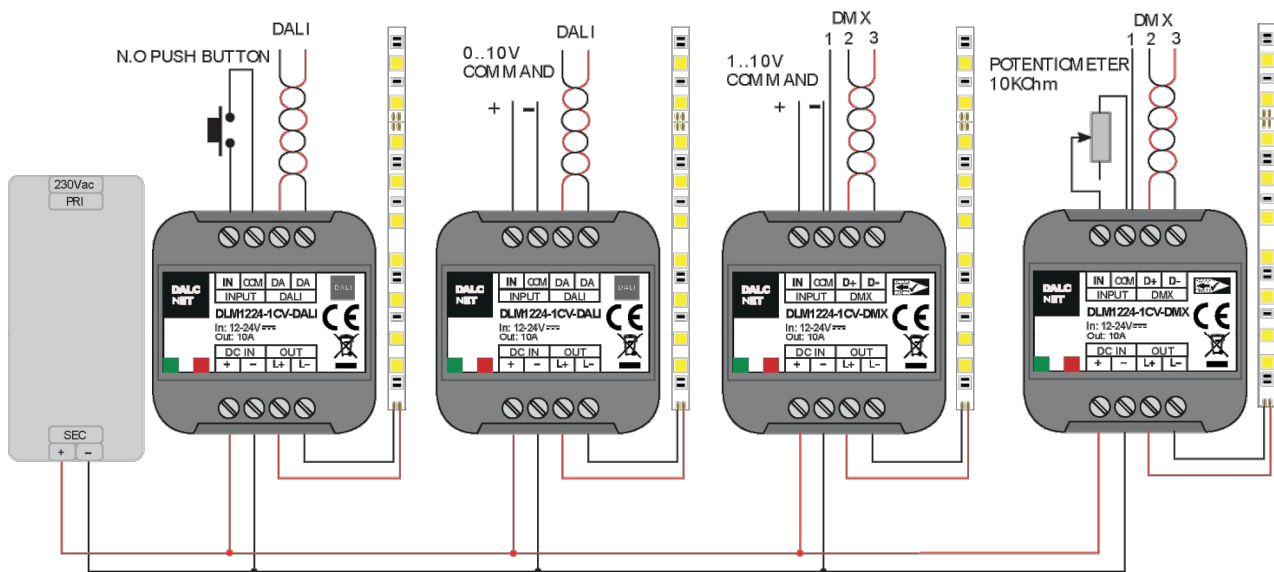

## Figura 19 - Picture 19

### Fase 19 - Step 19

Vista assonometrica / Isometric view

Rimontare il rosone.  
*Reassemble the canopy.*

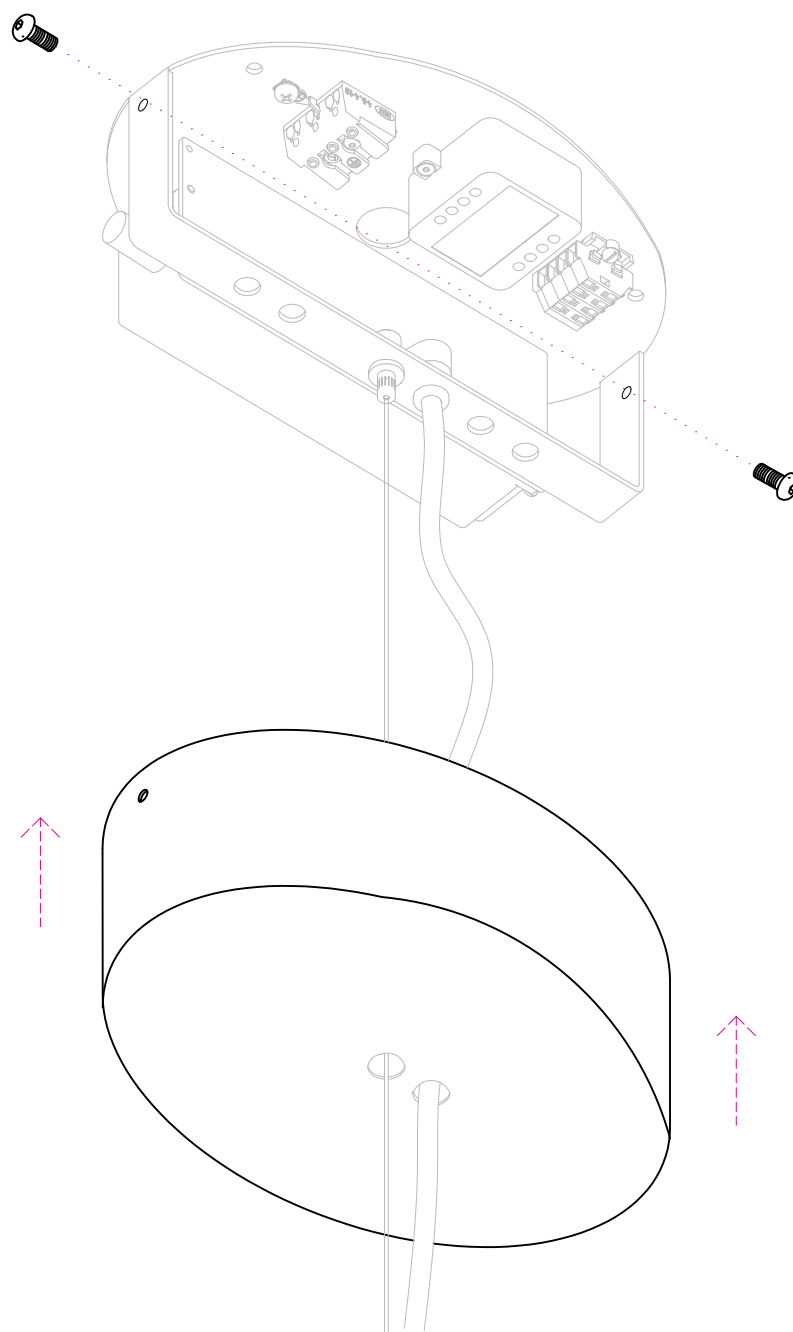

## Figura 20 - Picture 20

Fase 20 - Step 20

Vista frontale / Front view

Montaggio completato.  
Assembly completed.

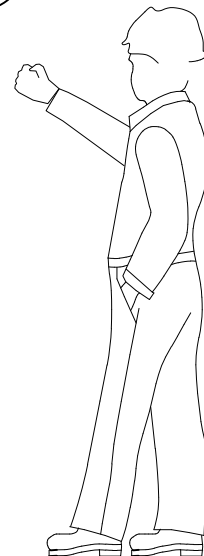
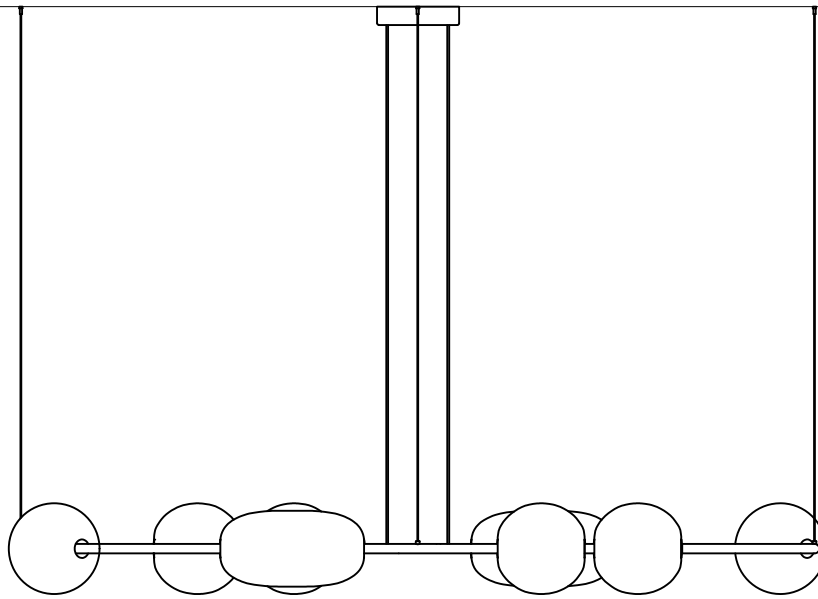



MADE IN ITALY

Classificazione apparecchi  
*Technical characteristics*

Classificazione secondo l'infiammabilità del piano d'appoggio.  
*Classification on the basis of the flammability of the supporting surface.*



L'apparecchio è idoneo all'installazione su superfici normalmente infiammabili (temperatura sulla base d'appoggio < 90°C).  
*The luminaire is suitable for mounting on normally flammable surfaces (temperature on supporting surface max. 90°C).*



L'apparecchio non è idoneo all'installazione su superfici normalmente infiammabili.  
*The luminaire is unsuitable for mounting on normally inflammable surfaces.*

0,1 m



Distanza minima di installazione dagli oggetti illuminati.  
*Minimum distance from lighted objects.*

CODICE IK Sistema di classificazione dei gradi di protezione degli involucri contro gli impatti meccanici.  
*IK CODE System for classifying the degrees of protection provided by the enclosure against mechanical impacts.*

Energia di impatto (J) / Impact Energy (J)

IK01	IK02	IK03	IK04	IK05	IK06	IK07	IK08	IK09	IK10
0,15	0,2	0,35	0,5	0,7	1	2	5	10	20

Classificazione secondo il grado di isolamento elettrico.

*Classification on the basis of the class of electrical insulation.*

Classe I - Class I

Apparecchio con isolamento elettrico fondamentale. Deve essere collegato al circuito di terra dell'impianto elettrico generale.  
*Electrical device with basic electrical insulation. Must be connected to the ground circuit of the main electrical system.*

Classe II - Class II



Apparecchio con doppio isolamento elettrico. Non necessita di collegamento al circuito di terra dell'impianto elettrico generale.  
*Electrical device with double insulation. Need not be connected to the ground circuit of the main electrical system.*

Classe III - Class III

## Grado di protezione IP

### Protection index

Il grado di protezione degli apparecchi di illuminazione viene indicato dalla sigla IP (international protection) seguita da due cifre di cui, la prima indica il grado di protezione contro l'ingresso dei corpi solidi e la seconda dei liquidi. Esempio: IP54 indica che l'apparecchio ha protezione 5 contro la penetrazione di solidi e 4 contro la penetrazione d'acqua.

*The degree of protection of light fixtures is indicated by the letters IP (international protection) followed by two figures, the first of which indicates the index of protection against the penetration of solid bodies and the second of liquids. For example: IP54 indicates that the device has an index of protection 5 against the penetration of solids and 4 against the penetration of water.*

Protezione dai solidi - Prima cifra IP

*Protection against solids - First IP figure*

#### **0 Non protetto**

*Not protected*

**1 Protetto dalla penetrazione di corpi solidi di dimensioni maggiori a 50 mm**

*Protected against penetration of solid bodies measuring more than 50 mm*

**2 Protetto dalla penetrazione di corpi solidi di dimensioni maggiori a 12 mm**

*Protected against penetration of solid bodies measuring more than 12 mm*

**3 Protetto dalla penetrazione di corpi solidi di dimensioni maggiori a 2,5 mm**

*Protected against penetration of solid bodies measuring more than 2.5 mm*

**4 Protetto dalla penetrazione di corpi solidi di dimensioni maggiori a 1 mm**

*Protected against penetration of solid bodies measuring more than 1 mm*

**5 Protetto contro la polvere**

*Protected against dust*

**6 Stagno contro la polvere**

*Sealed against dust*

Protezione dai liquidi - Seconda cifra IP

*Protection against liquids - Second IP figure*

#### **0 Non protetto**

*Not protected*

**1 Protetto contro gocce d'acqua che cadono verticalmente**

*Protected against drops of water falling vertically*

**2 Protetto contro gocce d'acqua che cadono con inclinazione massima di 15°**

*Protected against drops of water falling with a maximum angle of 15°*

**3 Protetto contro la pioggia**

*Protected against rain*

**4 Protetto contro gli spruzzi**

*Protected against splashes*

**5 Protetto contro i getti d'acqua**

*Protected against jets of water*

**6 Protetto contro le ondate**

*Protected against waves*

**7 Protetto contro l'immersione**

*Protected against immersion*

**8 Protetto contro la sommersione**

*Protected against submersion*

## Omologazioni

### Quality marking

#### **Marcatura CE**

*CE marking*

Tutti i prodotti sono conformi alle norme EN 60598-1 e alle parti seconde applicabili nonchè alle norme EMC applicabili.

La marcatura CE, applicata sugli articoli, testimonia la conformità alle direttive Europee: 73/23 CEE, 93/68 CE, 2006/95/CE, 2014/35/UE (direttiva di bassa tensione). 89/336 CEE, 93/68 CE, 2004/108/CE, 2014/30/UE (direttiva di compatibilità elettromagnetica).

*All the products are in compliance to EN 60598-1 and part two applicable standards and to EMC applicable standards. The CE marking, applied on the products, certify their conformity with the European directives: 73/23 CEE, 93/68 CE, 2006/95/CE, 2014/35/UE (Low Voltage Directive). 89/336 CEE, 93/68 CE, 2004/108/CE, 2014/30/UE (Electromagnetic Compatibility Directive).*

#### **RoHs**

Apparecchi conformi alla direttiva 2011/65/CE RoHs (direttiva sulla restrizione dell'uso di sostanze pericolose).

*Appliances in compliance to directive 2011/65/EC RoHs (directive on the restriction of the use of certain hazardous substances).*

**RAEE**

Gli apparecchi devono essere smaltiti a fine vita conformemente a quanto prescritto dalla direttiva 2012/19/EU RAEE (direttiva sui rifiuti di apparecchiature elettriche ed elettroniche).

*At the end of their live, the appliances shall be disposed according to the requirements of 2012/19/EU WEEE and its amendments (directive on waste of electrical and electronic equipment).*

**ErP**

Prodotti in conformità con la direttiva 2009/125/CE ErP (Energy related Products) ed ai regolamenti applicativi europei 1194/2012 e 245/2009 e (UE) 2015/1428 riguardanti la progettazione ecocompatibile dei prodotti.

*Products in conformity to 2009/125/EC ErP (Energy related Products) directive and to regulations 1194/2012 and 245/2009 and (UE) 2015/1428 establishing a frame work for the setting of ecodesign requirements for energyrelated products.*

**EEL**

Prodotti in conformità con la direttiva EEL (Energy Efficiency Label) ed al regolamento applicativo europeo 874/2012 riguardanti l'indicazione del consumo di energia e di altre risorse dei prodotti connessi all'energia mediante l'etichettatura ed informazioni uniformi relative ai prodotti.

*Products in conformity to EEL (Energy Efficiency Label) directive and to regulation 874/2012 regarding indication by labelling and standard product information of the consumption of energy and other resources by energy-related products.*





MADE IN ITALY

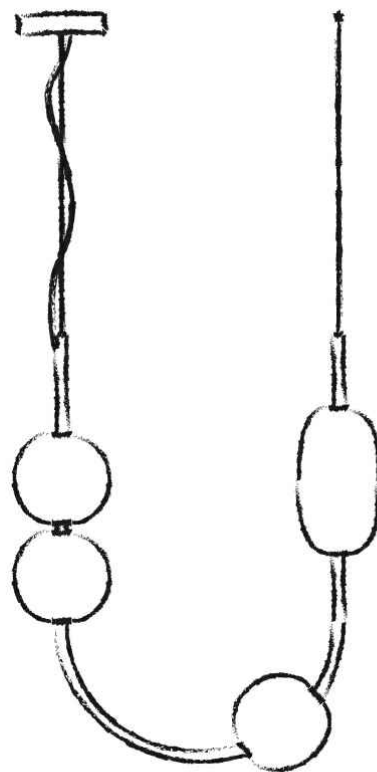

SOSPENSIONE VERTICALE - SATELLITE -  
VERTICAL HANGING LAMP

# SATELLITE Studio Pepe



Verticale / Vertical 90x24 h 113  
Lampada sospensione  
Hanging Lamp

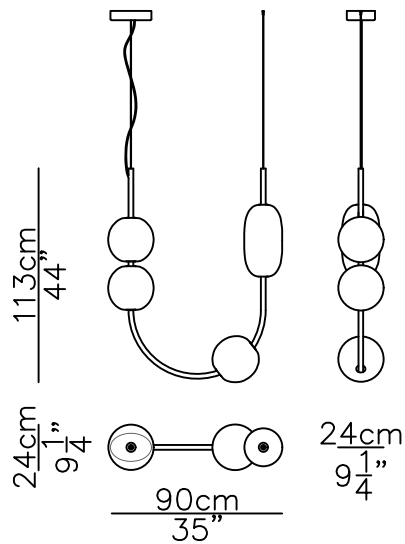

# SATELLITE Studio Pepe

## LAMPADA VERTICALE / VERTICAL LAMP

SORGENTE LUMINOSA LIGHT SOURCE	POTENZA POWER	FLUSSO LUMINOSO LUMEN FLUX	ALIMENTAZIONE SUPPLY	TEMPERATURA COLOUR TEMPERATURE	INDICE RESA CROMATICA COLOUR RENDERING INDEX
LED STRIP	24	4700	110÷240 V	3000 °K	>90



Tutti i prodotti sono conformi alle norme EN 60598-1 e alle parti seconde applicabili nonché alle norme EMC applicabili.

All the products are in compliance to EN 60598-1 and part two applicable standards and to EMC applicable standards.

# IP20

Protetto dalla penetrazione di corpi solidi di dimensioni maggiori a 12 mm  
- Non protetto

Protected against penetration of solid bodies measuring more than 12 mm  
- Not protected

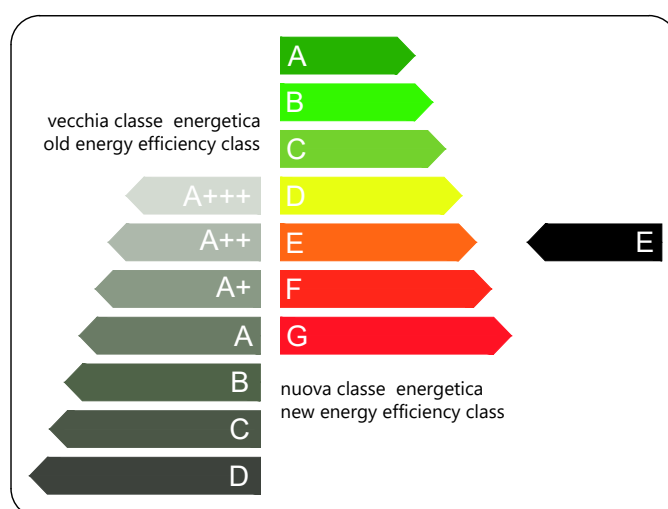

# COMPONENTI / COMPONENTS

n° 02 - Corpo lampada / *Lamp*

n° 03 - Paralume forma sferica / *Spherical lampshade*

n° 01 - Paralume forma ovale / *Oval lampshade*

n° 08 - Ghiera metallica + ferma ghiera / *Metal locking ring*

n° 16 - Copri ghiera magnetici / *Magnetic ring cover*

n° 04 - Tasselli + viti da muro / *Fasteners + wall screws*

n° 16 - Viti svasate M3x4mm / *Flat head screw M3x4mm*



Ingombro piastra e interasse fori. ( *Figura 1 - Fase 1* )  
*Bracket's size and holes's centre distance. ( Picture 1 - Step 1 )*



## Figura 2 - Picture 2

### Fase 2 - Step 2

Vista frontale / Front view

Estrarre dalla scatola la lampada che sarà divisa in due strutture.  
*Take the lamp out of the box. It is supplied in two structures.*

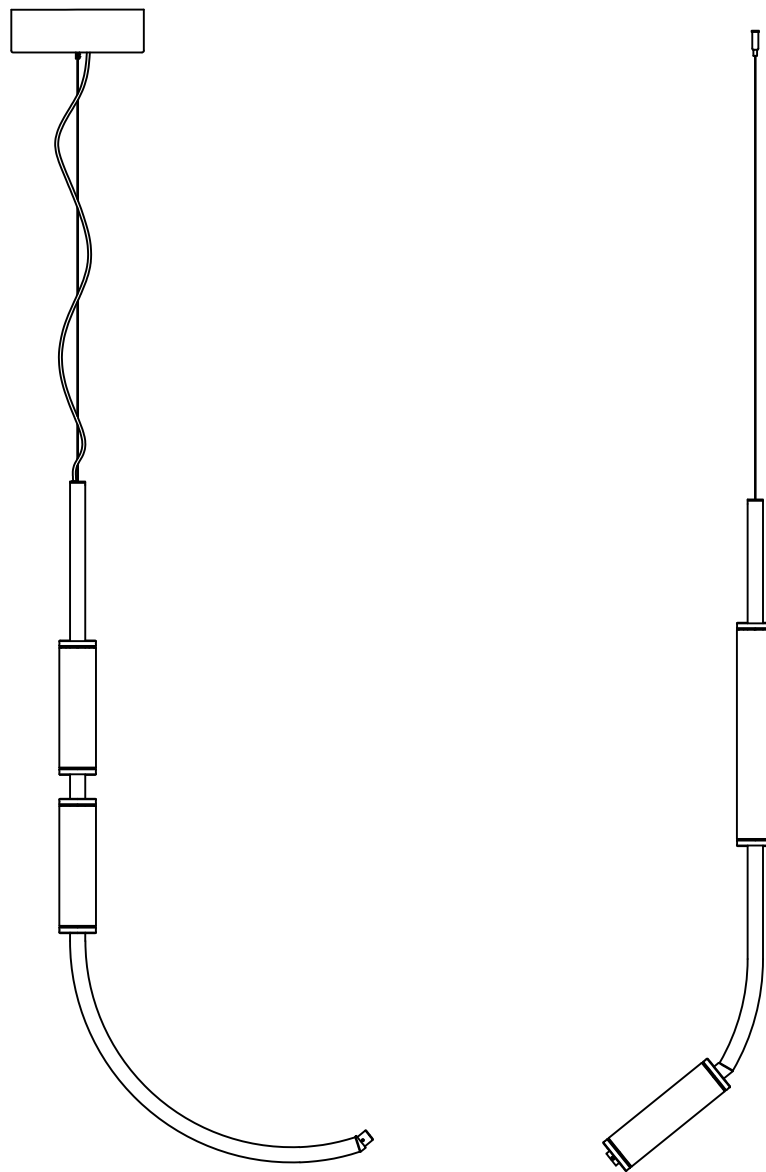

## Figura 3 - Picture 3

### Fase 3 - Step 3

Vista frontale / Front view

Rimuovere cavi in acciaio, svitare rosone e scollegare cavi elettrici  
*Remove the suspension cables, remove the canopy and disconnect electrical cables.*

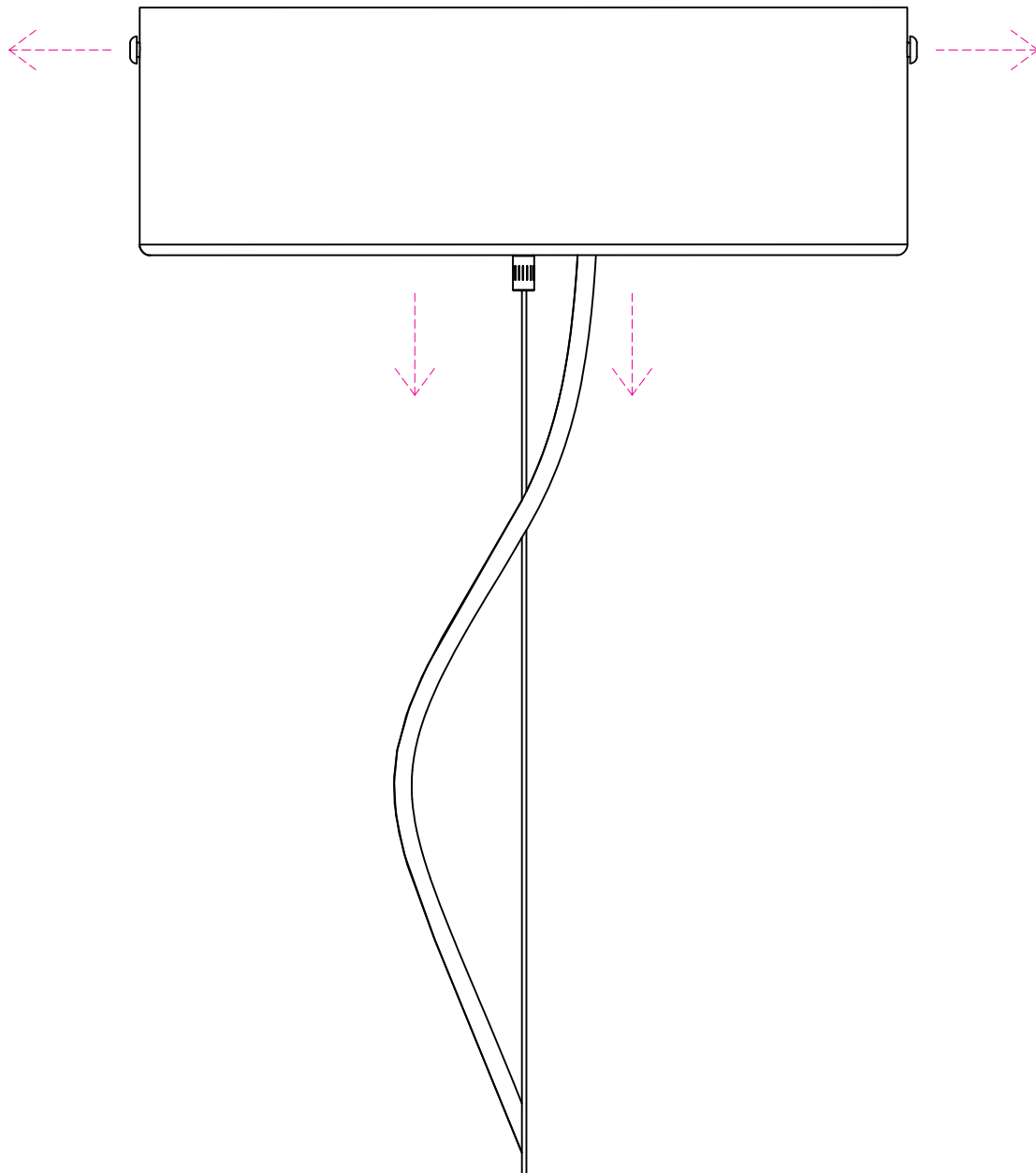

## Figura 4 - Picture 4

### Fase 4 - Step 4

Vista assonometrica / Isometric view

Segnare la posizione ed effettuare i fori per fissare la piastra a soffitto.  
Mark the position and drill the holes to fix the metal bracket on ceiling.

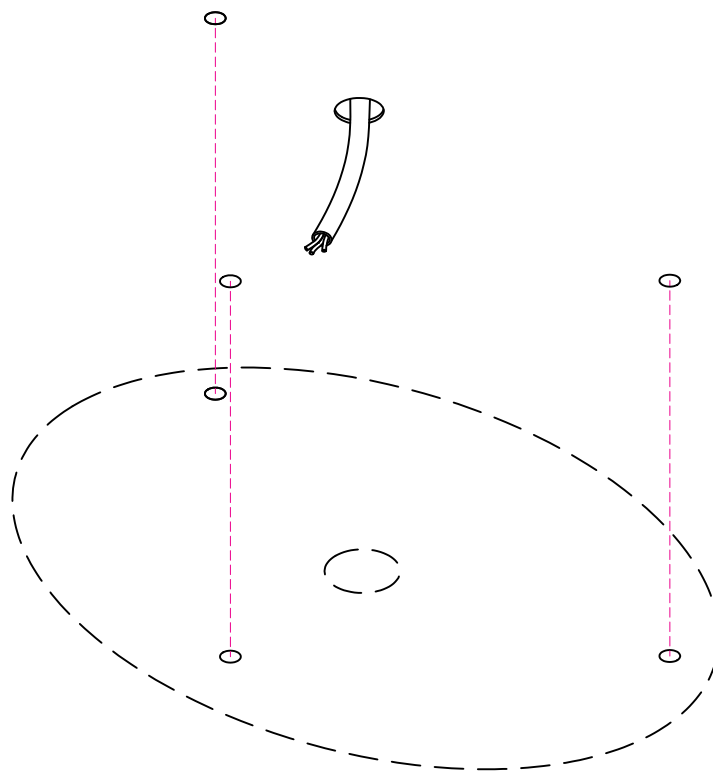
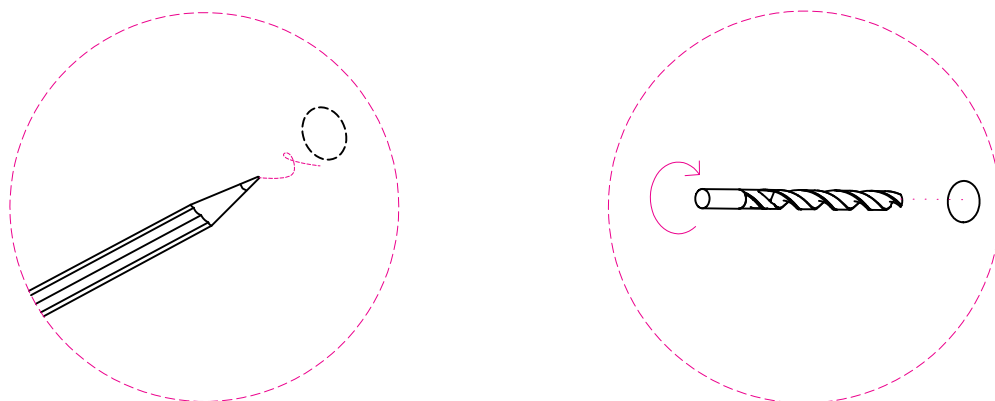

## Figura 5 - Picture 5

### Fase 5 - Step 5

Vista assonometrica / Isometric view

Inserire i tasselli nei fori, far passare i cavi attraverso la staffa e avvitare a soffitto.

*Insert the anchors in the holes, thread the cables through the bracket and screwd it on ceiling.*

**Staffa**  
**Bracket**

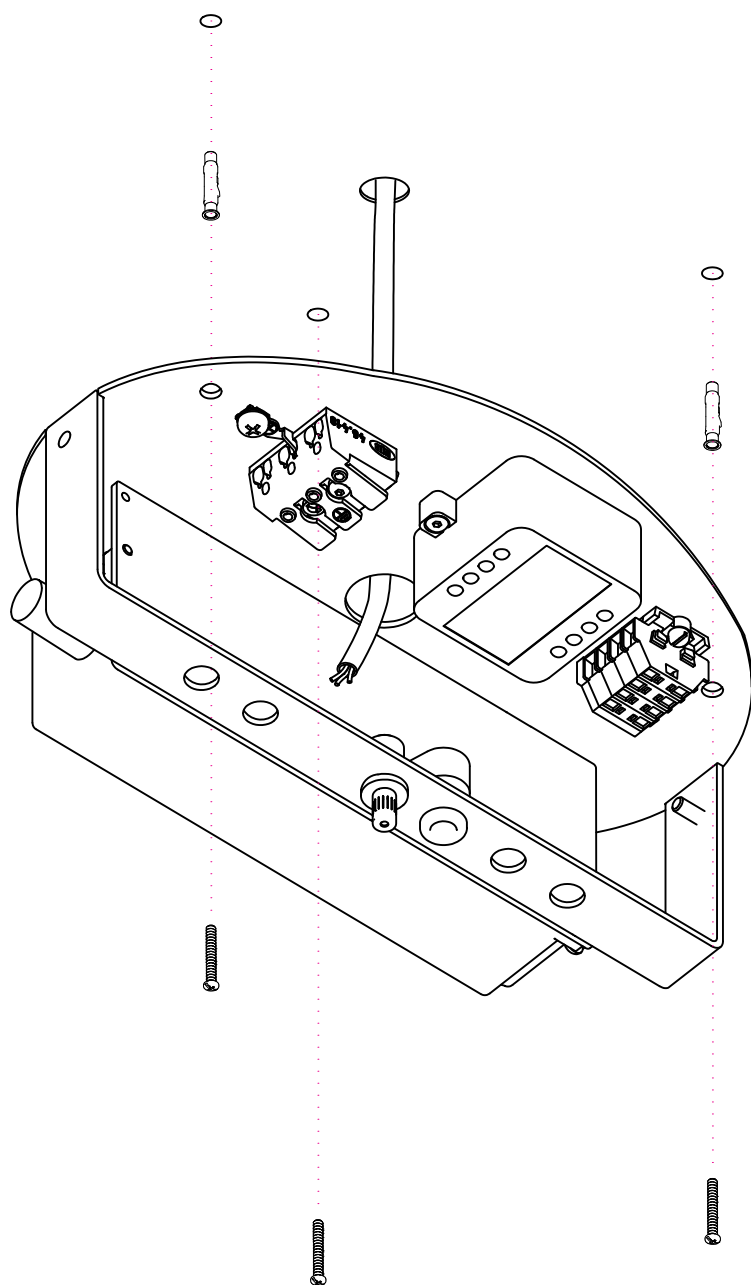

**Pendini**  
**Suspension cable**

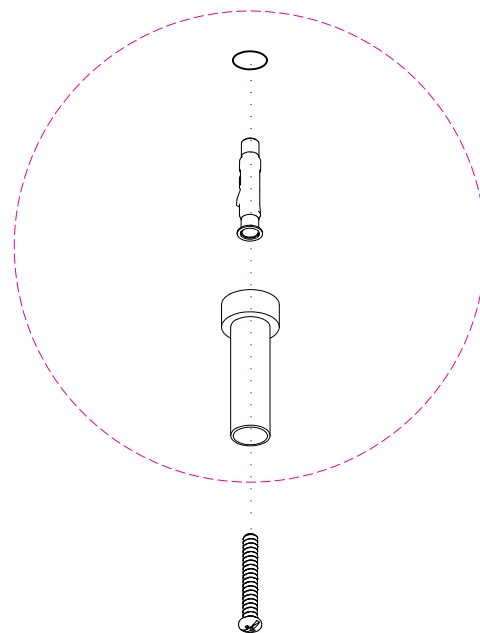

## Figura 6 - Picture 6

### Fase 6 - Step 6

Vista frontale / Front view

Montare le ghiera metalliche nelle posizioni indicate.  
Install the metal locking rings in the indicated positions.

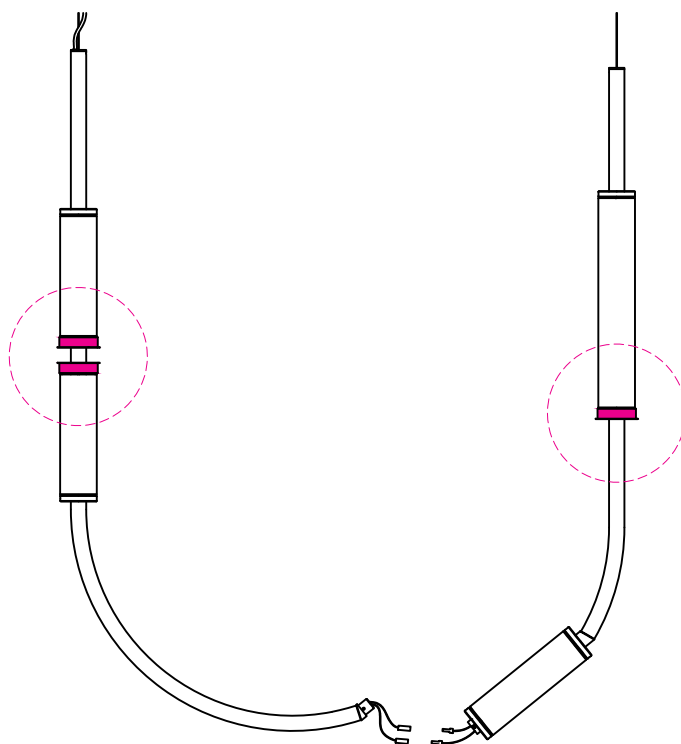

Vista assometrica / Isometric view

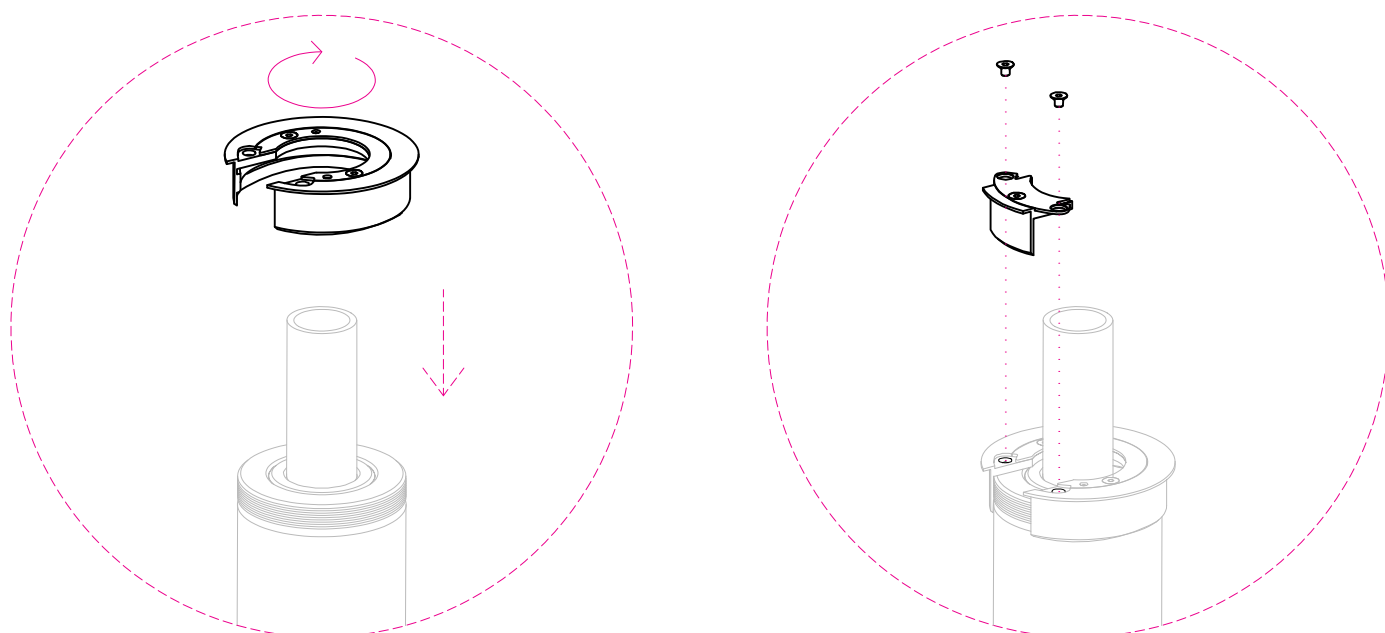

## Figura 7 - Picture 7

### Fase 7 - Step 7

Vista frontale / Front view

Inserire il primo paralume e fissarlo avvitando la ghiera metallica.  
*Insert the first lampshade and secure it by screwing on the metal locking ring.*

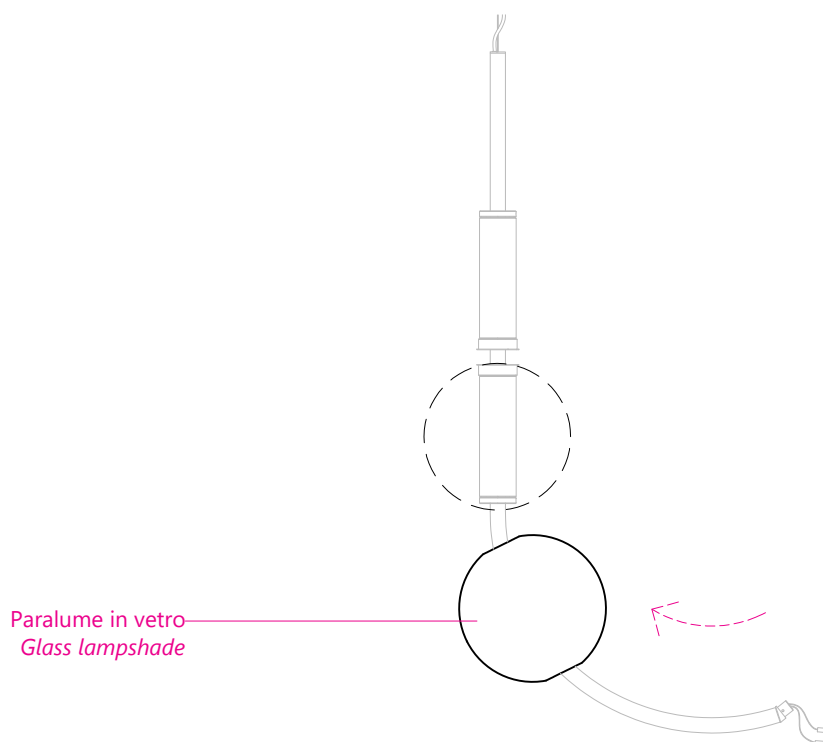

Vista assometrica / Isometric view

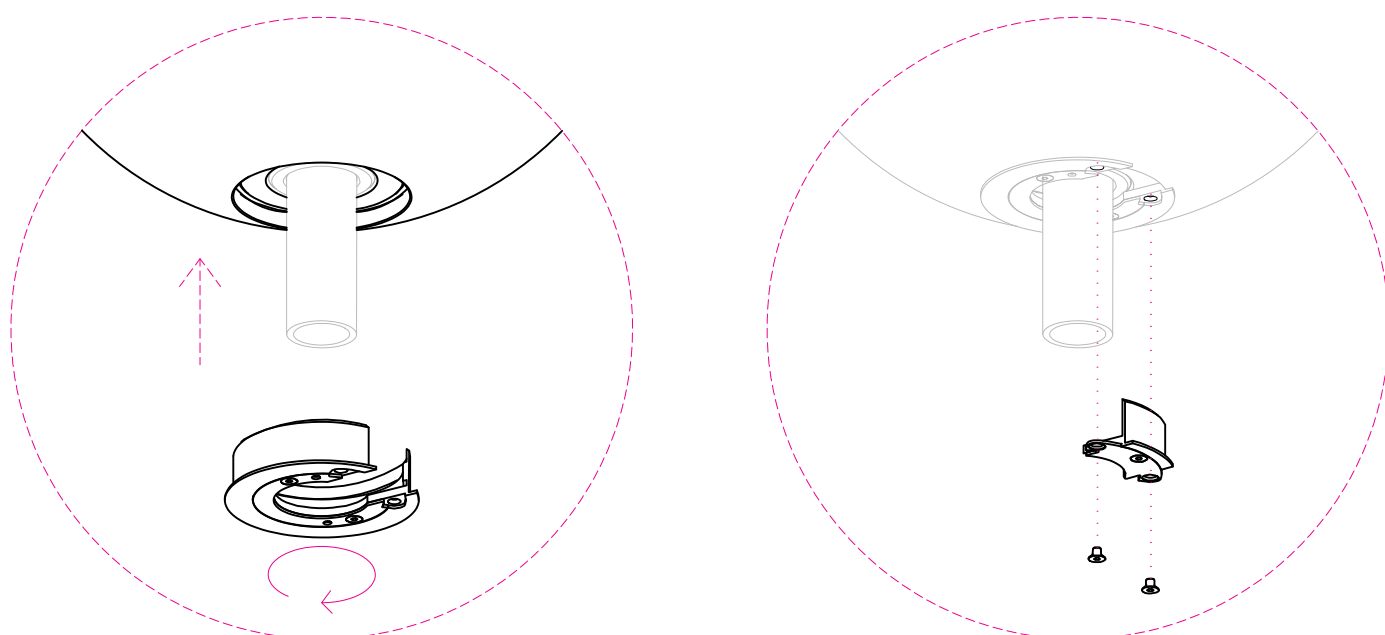

## Figura 8 - Picture 8

### Fase 8 - Step 8

Vista frontale / Front view

Inserire il secondo paralume nella seconda struttura, oltre la sua posizione ultima. Effettuare il collegamento elettrico tra le due strutture.

*Slide the second shade onto the second structure, pushing it beyond its final position. Establish the electrical connection between the two frames.*

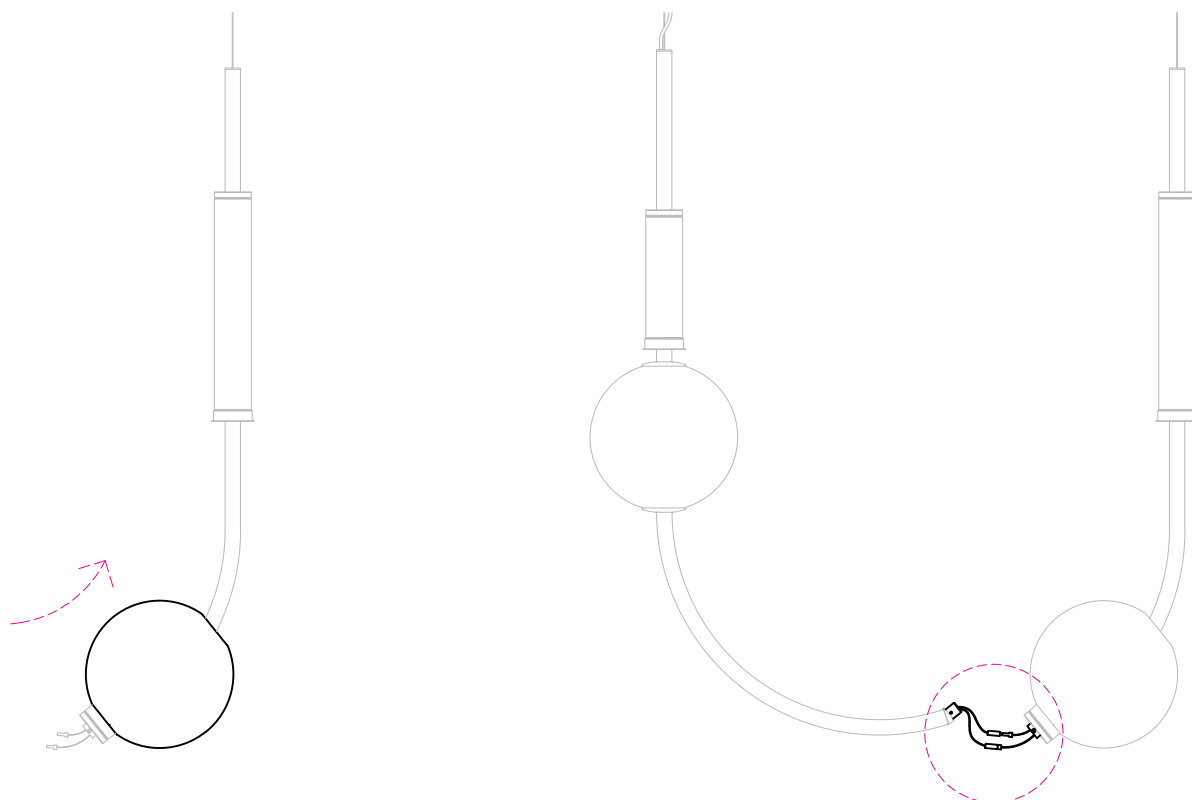

Vista assometrica / Isometric view

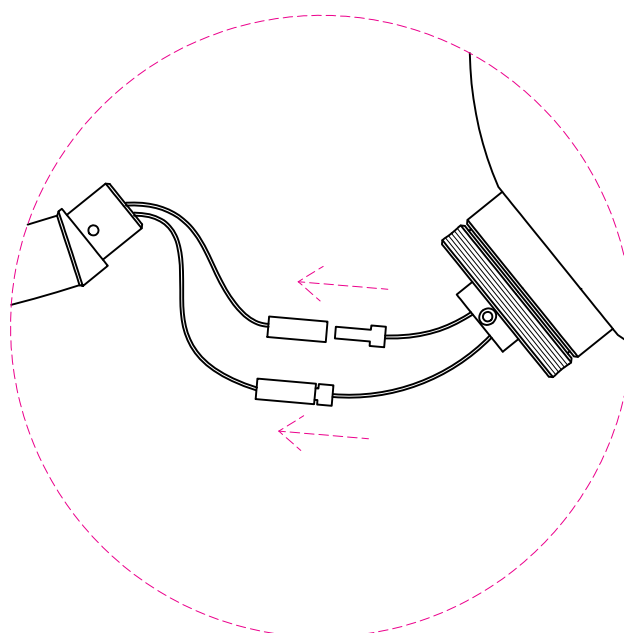

## Figura 9 - Picture 9

### Fase 9 - Step 9

Vista frontale / Front view

Collegare le due strutture inserendo i tubi uno dentro l'altro.  
Avvitare le viti.  
*Connect the two frames by sliding the tubes into each other. Tighten the screws.*

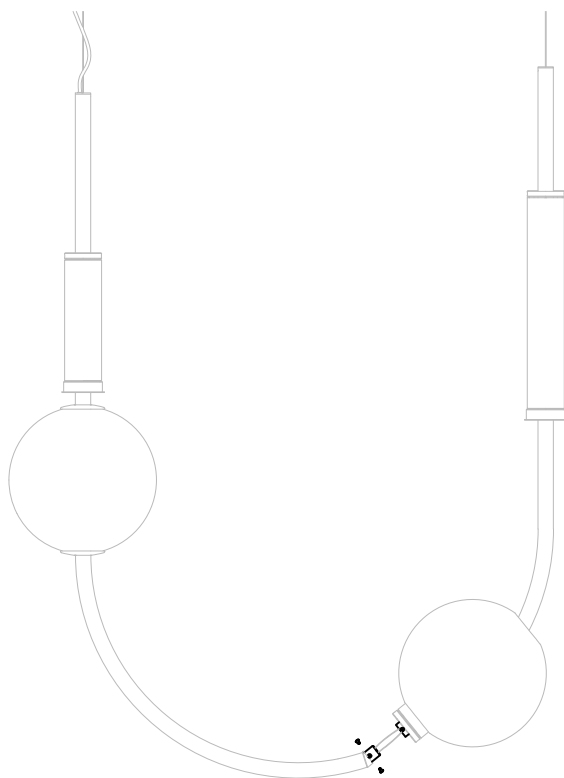

Vista assonometrica / Isometric view

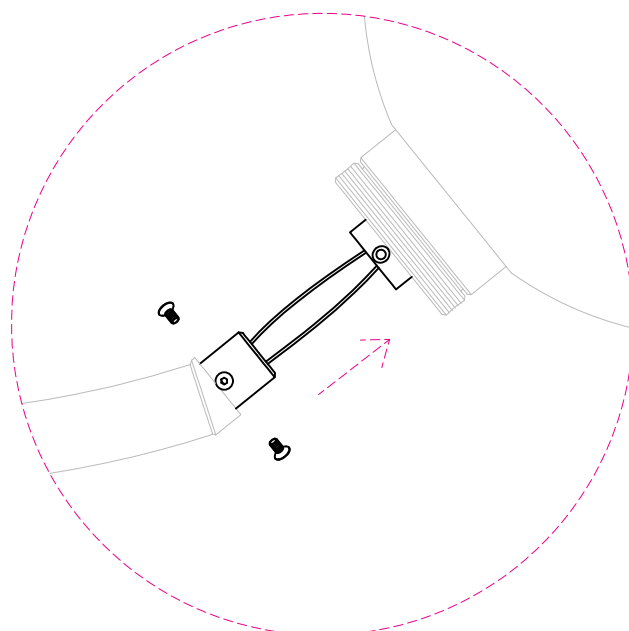

## Figura 10 - Picture 10

### Fase 10 - Step 10

Vista frontale / Front view

Far scorrere il paralume in posizione e fissarlo avvitando la ghiera metallica.  
Slide the lampshade into position and secure it by screwing on the metal locking ring.

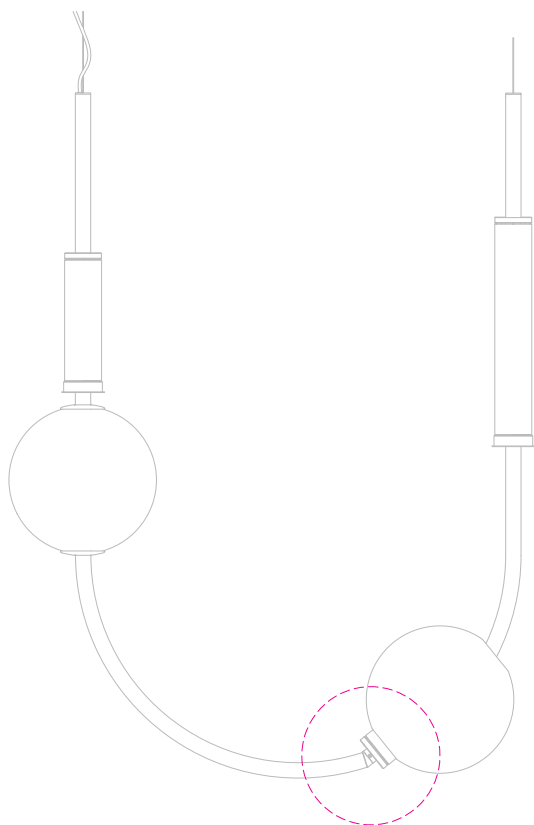

Vista assonometrica / Isometric view

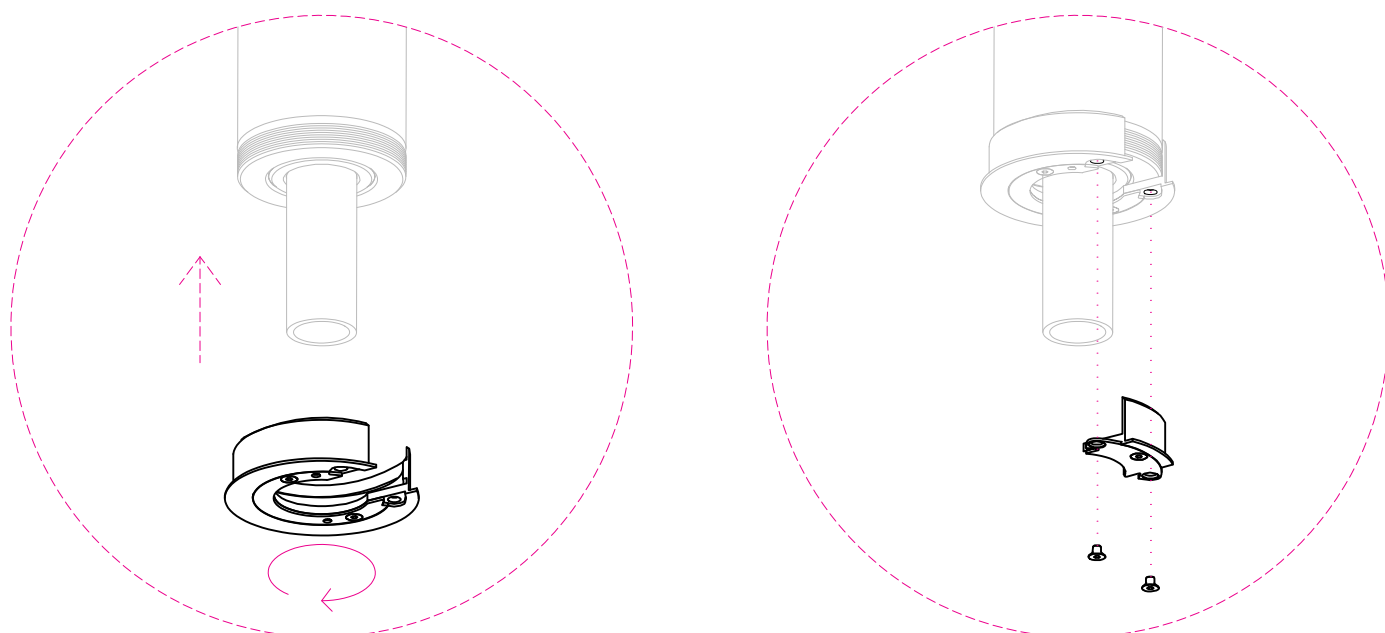

## Figura 11 - Picture 11

### Fase 11 - Step 11

Vista frontale / Front view

Far scorrere il paralume in posizione e fissarlo avvitando la ghiera metallica.  
*Slide the lampshade into position and secure it by screwing on the metal locking ring.*

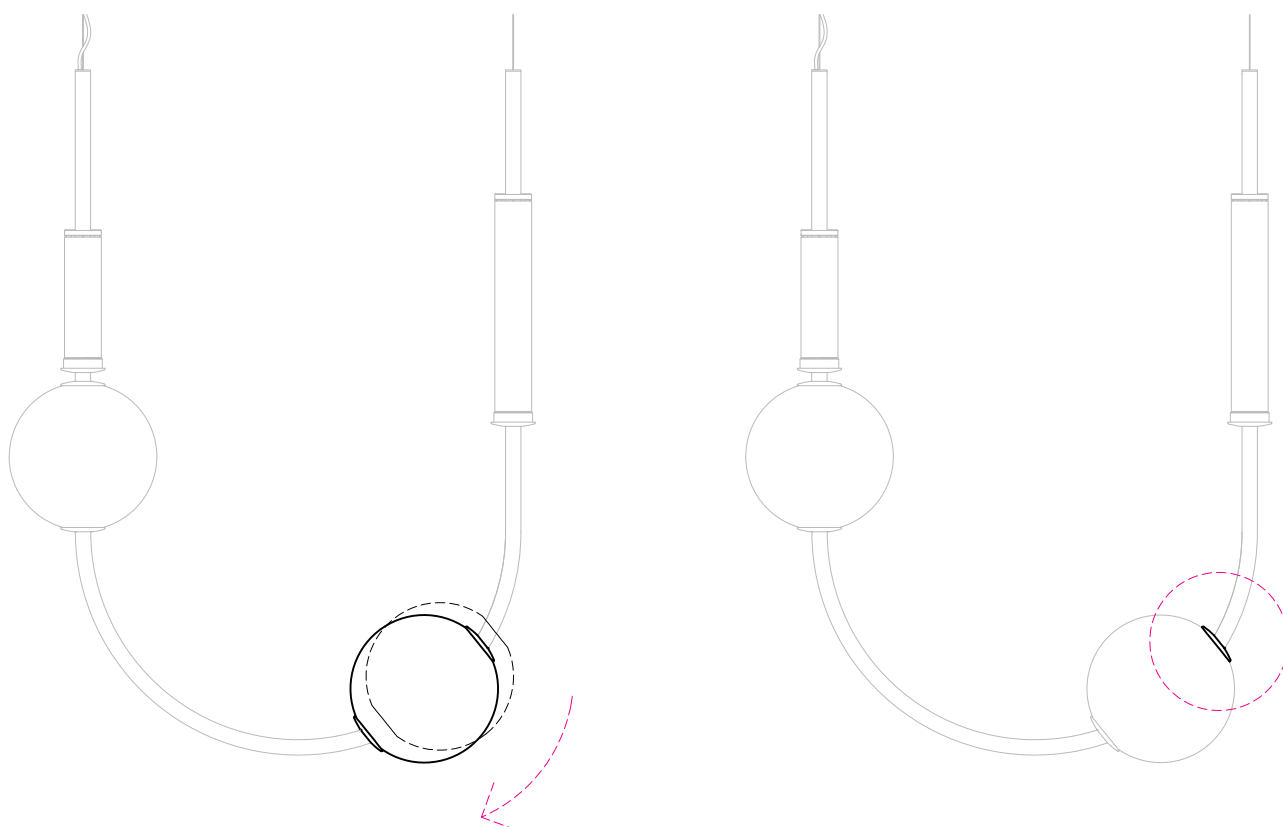

Vista assometrica / Isometric view

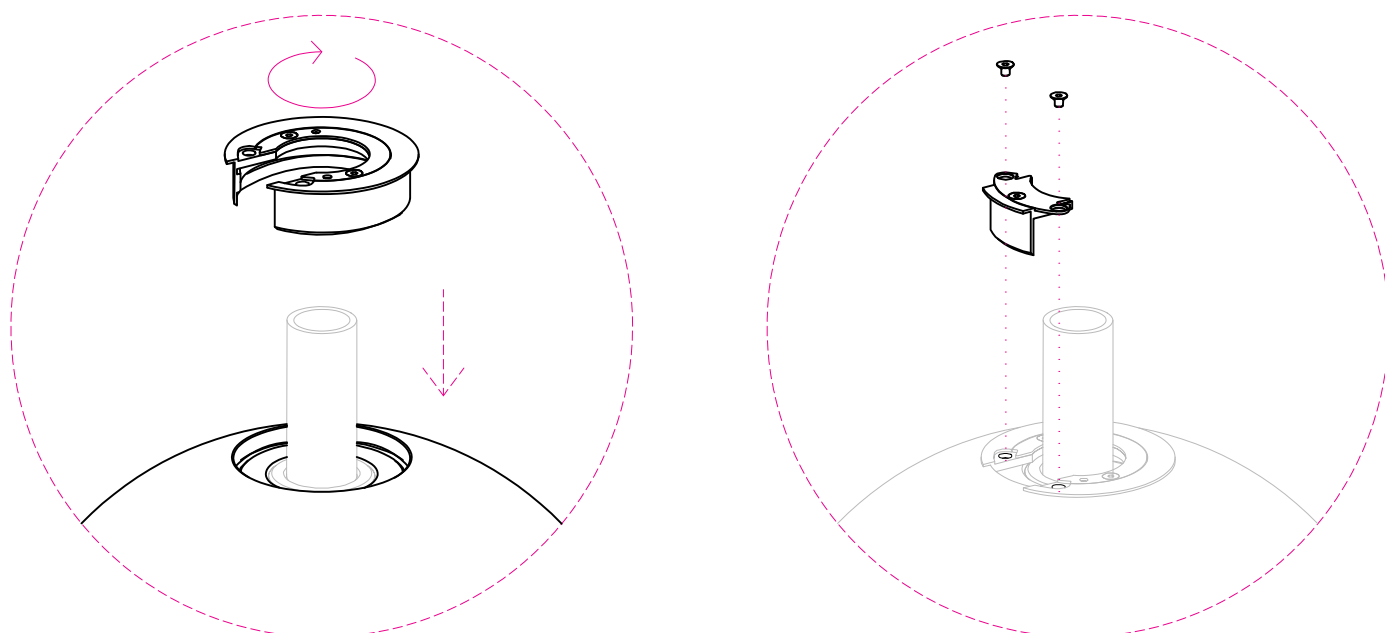

## Figura 12 - Picture 12

### Fase 12 - Step 12

Vista frontale / Front view

Inserire il terzo paralume e fissarlo avvitando la ghiera metallica.  
*Insert the third lampshade and secure it by screwing on the metal locking ring.*

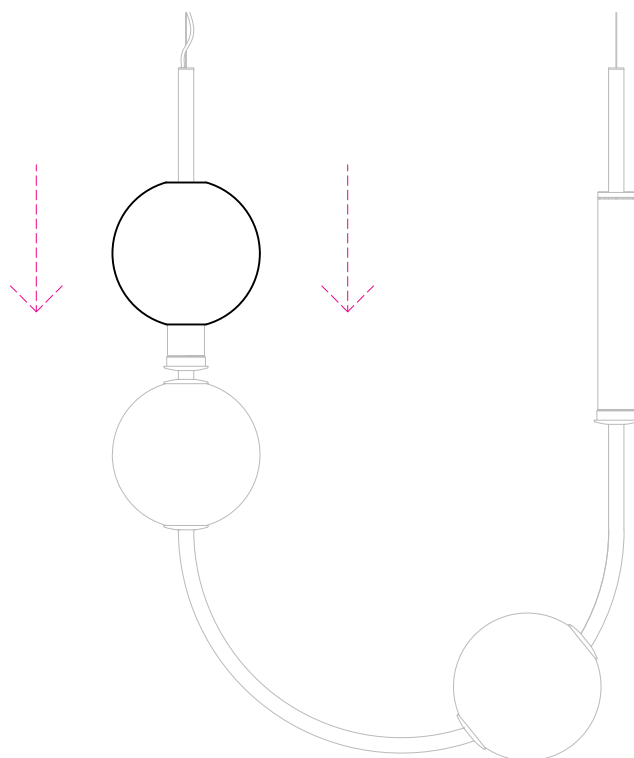

Vista assometrica / Isometric view

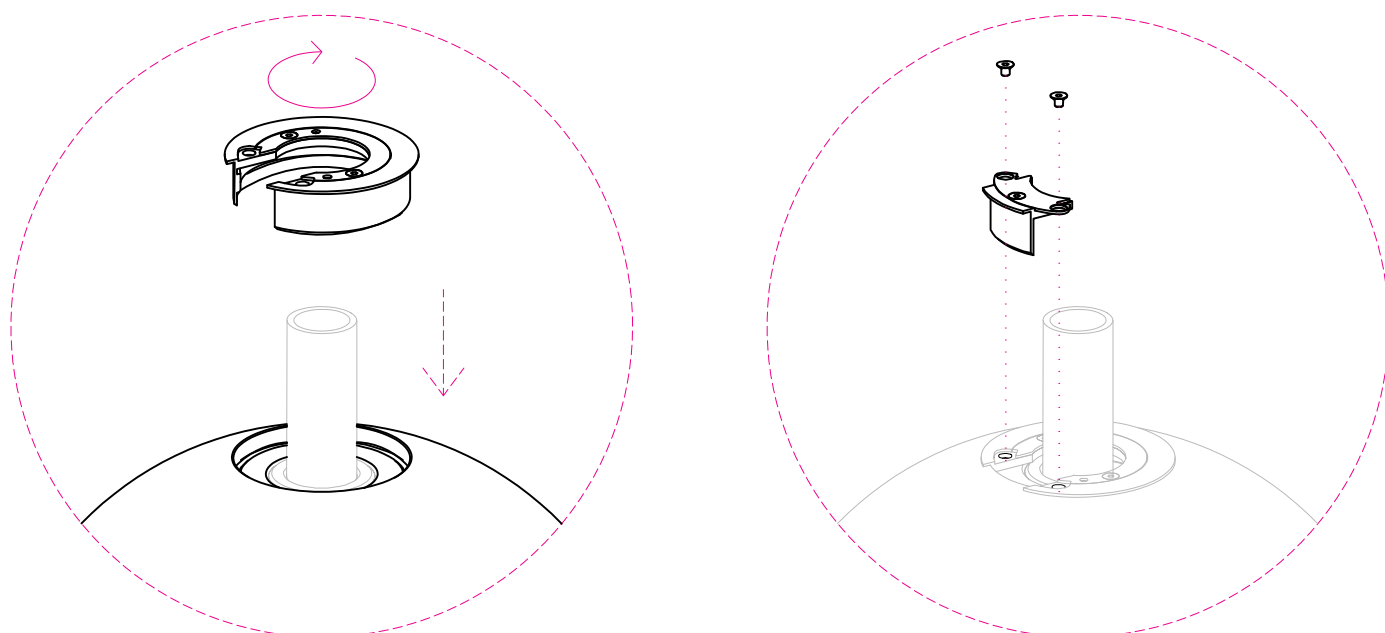

## Figura 13 - Picture 13

### Fase 13 - Step 13

Vista assonometrica / Isometric view

Inserire il quarto paralume e fissarlo avvitando la ghiera metallica.  
*Insert the fourth lampshade and secure it by screwing on the metal locking ring.*

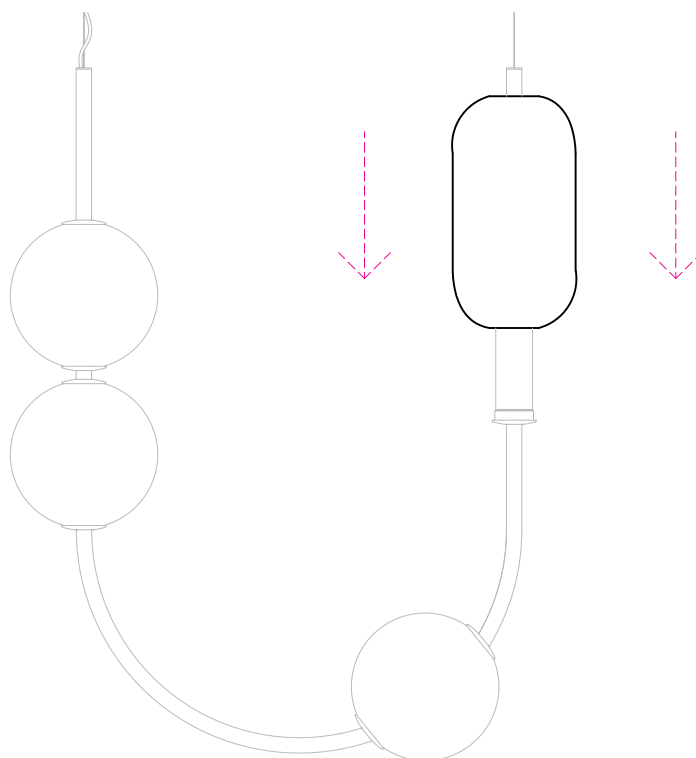

Vista assonometrica / Isometric view

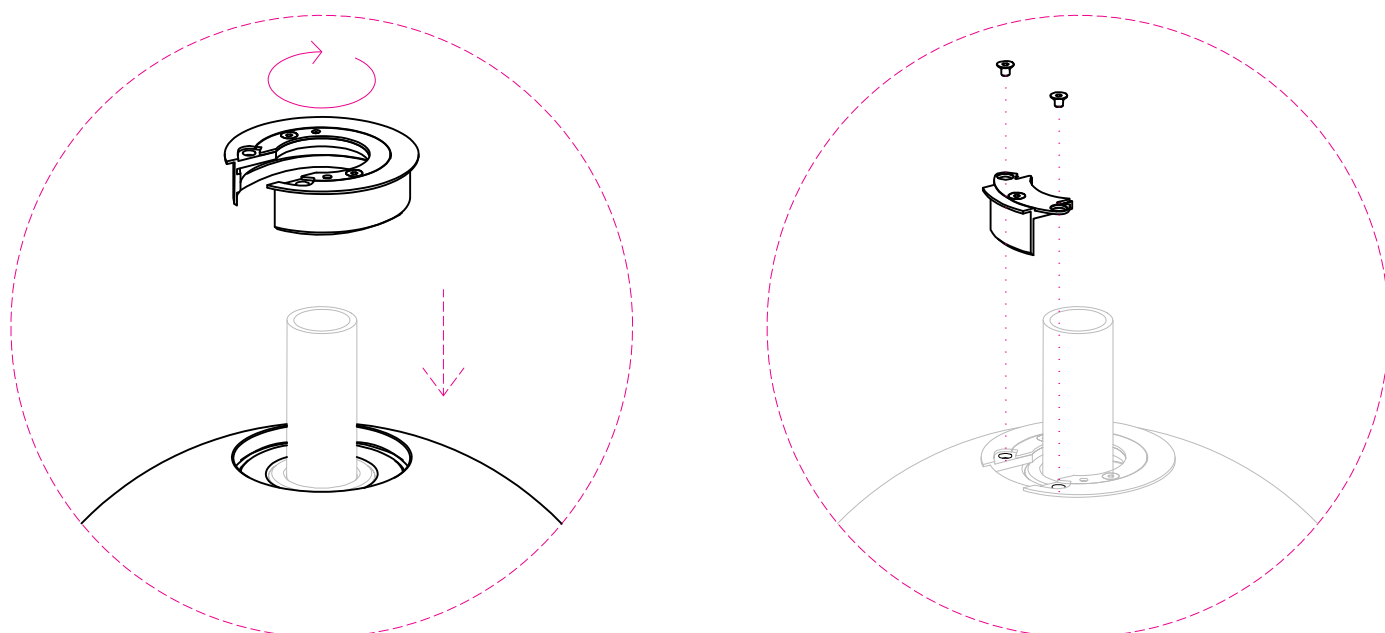

## Figura 14 - Picture 14

### Fase 14 - Step 14

Vista assonometrica / Isometric view

Dopo aver fissato tutti i paralumi, posizionare i copri ghiera magnetici.  
After securing all the lampshades, place the magnetic ring covers.

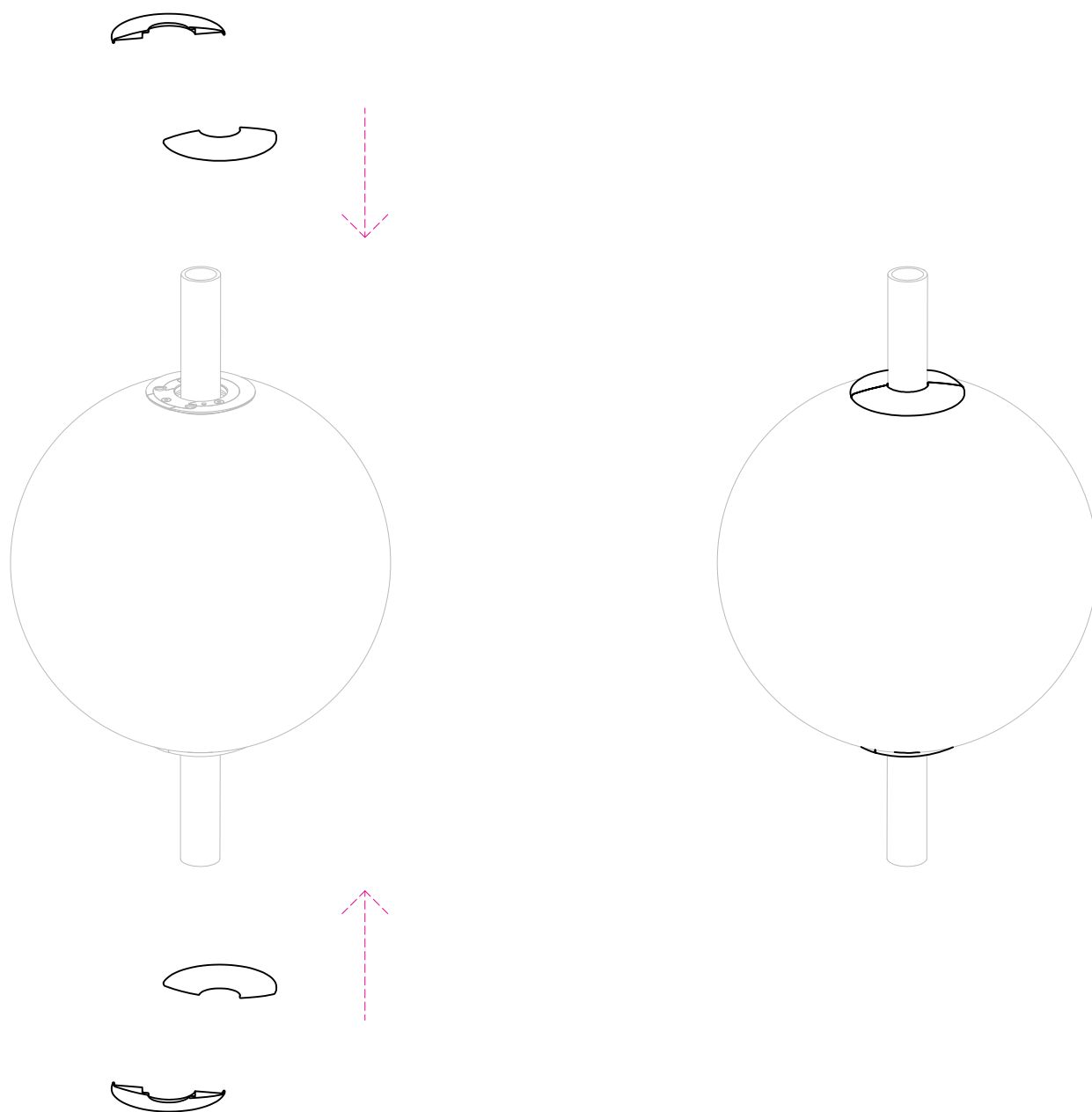

## Figura 15 - Picture 15

### Fase 15 - Step 15

Vista assonometrica / Isometric view

Inserire i cavi in acciaio all'interno del ferma cavo.

Regolare la lunghezza della lampada premendo delicatamente il ferma cavo.

Durante la regolazione premere con la punta del dito senza piegare il cavo metallico.

*Insert the steel cables into the cable blocker.*

*Adjust the lamp's length by gently pressing the cable blocker. While adjusting, press with your fingertip without bending the metal cable.*

#### Rosone Canopy

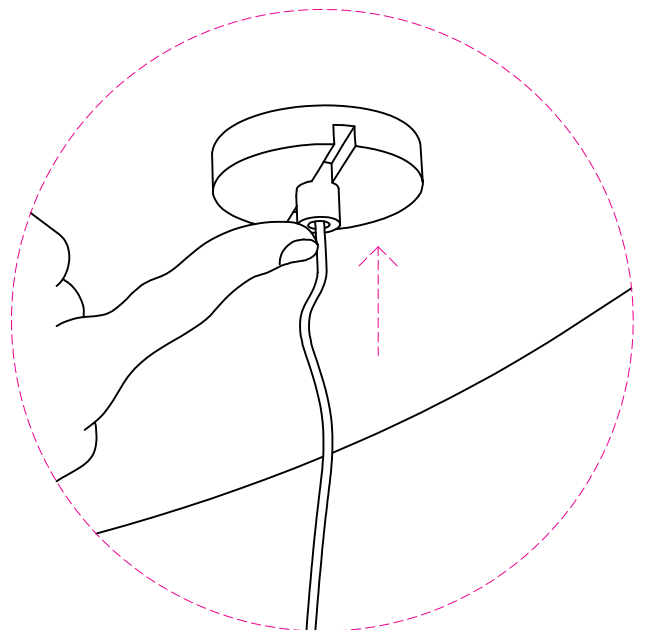
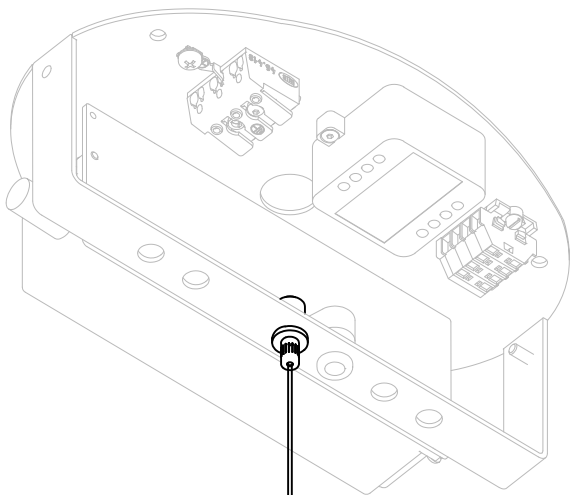

#### Pendini Suspension cable

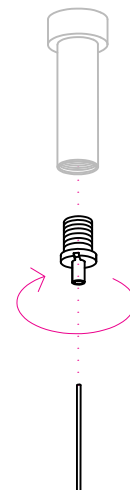

## Figura 16 - Picture 16

### Fase 16 - Step 16

Vista assonometrica / Isometric view

Infilare i cavi di alimentazione nel fermacavo della staffa.  
*Insert the power cable into the bracket clamp.*

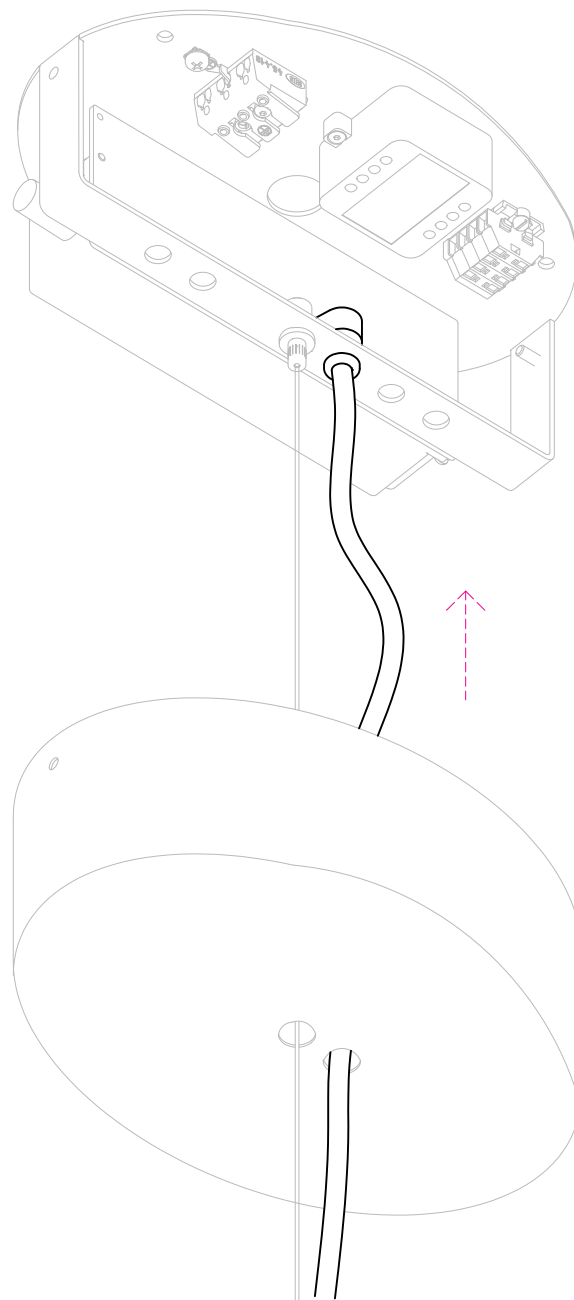



## Figura 18 - Picture 17

### Fase 18 - Step 18

Vista assonometrica / Isometric view

Rimontare il rosone.  
*Reassemble the canopy.*

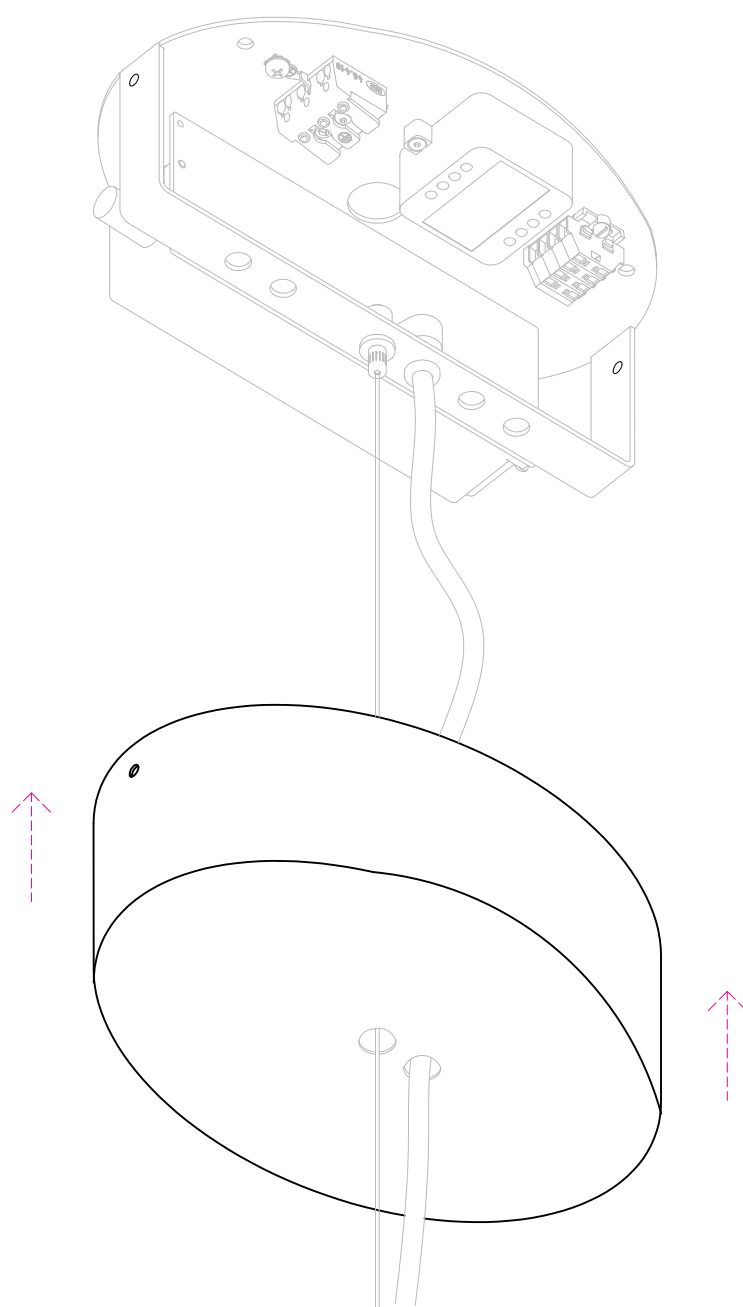

## Figura 19 - Picture 19

### Fase 19 - Step 19

Vista assonometrica / Isometric view

Rimontare il rosone.  
*Reassemble the canopy.*

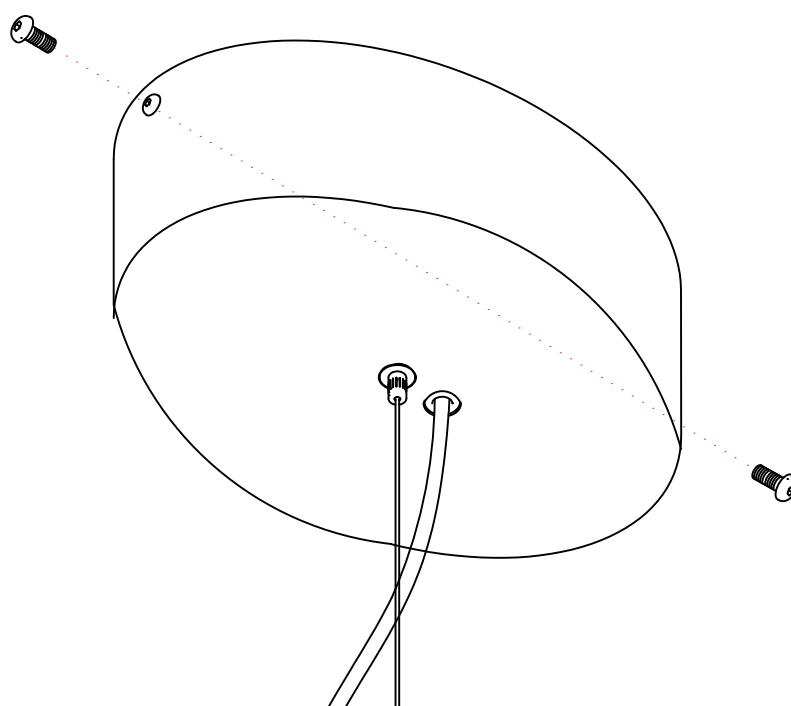

## Figura 20 - Picture 20

Fase 20 - Step 20

Vista frontale / Front view

Montaggio completato.  
Assembly completed.

